

STRIKES

CAL-ROYAL

ASA Strikes



CR-ASA478
US3, 10, 10B, 26, 32D
ASA Strike

CR-ASAST
US3, 26D
Steel ASA

DON-JO

STRIKES

Deadbolt Type ANSI Strike



<u>Stock No.</u>	<u>Finish</u>
DJ-BFD2 BP	Steel Brass Plated
DJ-BFD2 SL	Steel Silver Coated

4-7/8" X 1-1/4"
13ga. (.095)

Blank ANSI Strike



<u>Stock No.</u>	<u>Finish</u>
DJ-BS161 605	Solid Brass
\$DJ-BS161 612	Solid Bronze
DJ-BS161 626	Dull Chrome
DJ-BS161 630	Stainless Steel

4-7/8" X 1-1/4"
13ga. (.095)

\$-Discontinued. Call for closeout prices.

Deadbolt Strike



\$-Discontinued. Call for closeout prices.

<u>Stock No.</u>	<u>Finish</u>
\$DJ-DBS1478 605	Polished Brass
\$DJ-DBS1478 626	Satin Chrome

4-7/8" X 1-1/4"
13ga. (.095)

ASA Mortise Strikes



<u>Stock No.</u>	<u>Finish</u>
DJ-MST261 BP	Steel Brass Plated
DJ-MST261 SL	Steel Silver Coated

4-7/8" X 1-1/4"
13ga. (.095)

Standard ANSI Strike



4-7/8" X 1-1/4"
13ga. (.095)

<u>Stock No.</u>	<u>Finish</u>
DJ-ST161 605	Solid Brass Lacquered
DJ-ST161 612	Solid Bronze Lacquered
DJ-ST161 613	Duro Coated
DJ-ST161 625	Brass, Bright Chrome Plated
DJ-ST161 626	Brass, Dull Chrome Plated
DJ-ST161 630	Stainless Steel
<u>Stock No.</u>	<u>Finish</u>
DJ-ST261 BP	Steel Brass Plated
DJ-ST261 SL	Steel Silver Coated

T Strike



2-3/4" X 1-1/8"
18ga. (.050)

<u>Stock No.</u>	<u>Finish</u>
DJ-TS-234 605	Polished Brass
DJ-TS-234 630	Stainless Steel

STRIKES

DON-JO

STRIKES

2-1/4" Extended Lip Strike

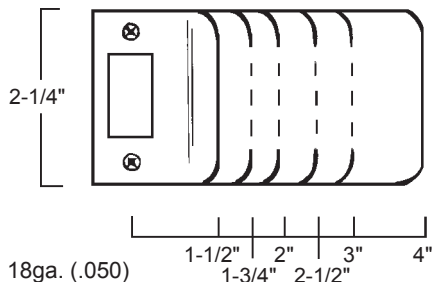

Stock No.	Finishes	Size
DJ-EL102	605, 609, 619, 620, 630	2-1/4" x 2"
*DJ-9102	605, 609, 619, 620, 630	2-1/4" x 2"
DJ-EL103	605, 609, 630	2-1/4" x 3"
*DJ-9103	605, 630	2-1/4" x 3"
DJ-EL104	605, 609, 630	2-1/4" x 4"
DJ-EL115	605, 609, 619, 620, 630	2-1/4" x 1-1/2"
*DJ-9115	605, 609, 619, 620, 630	2-1/4" x 1-1/2"
DJ-EL125	605, 609, 630	2-1/4" x 2-1/2"
*DJ-9125	605	2-1/4" x 2-1/2"
DJ-EL175	605, 609, 619, 620, 630	2-1/4" x 1-3/4"
*DJ-9175	605, 619, 620, 630	2-1/4" x 1-3/4"

*SAVE MONEY: DJ-9102, DJ-9103, DJ-9115, DJ-9125 and DJ-9175 are polybagged and sold in multiples of 10.

2-3/4" Extended Lip Strike

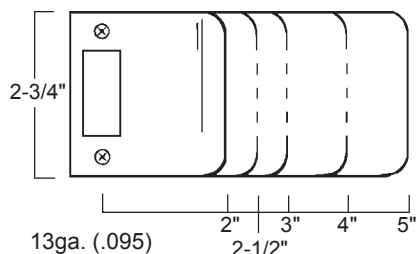

Stock No.	Finishes	Size
DJ-EL202	BP	2-3/4" x 2"
DJ-EL203	BP	2-3/4" x 3"
DJ-EL204	BP	2-3/4" x 4"
DJ-EL205	BP	2-3/4" x 5"
DJ-EL225	BP	2-3/4" x 2-1/2"

Don Jo Finishes:

605	Bright Brass
609	Antique Brass
612	Satin Bronze
619	Satin Nickel
620	Antique Nickel
630	Satin Stainless Steel
BP	Brass Plated

4-7/8" Extended Lip ANSI Strike

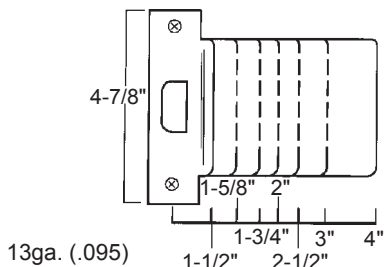

Stock No.	Finishes	Size
DJ-EST102	605, 612, 630	4-7/8" x 2"
DJ-EST103	605, 612, 630	4-7/8" x 3"
DJ-EST104	605, 612, 630	4-7/8" x 4"
DJ-EST115	605, 612, 630	4-7/8" x 1-1/2"
DJ-EST125	605, 612, 630	4-7/8" x 2-1/2"
DJ-EST158	630	4-7/8" x 1-5/8"
DJ-EST175	605, 612, 630	4-7/8" x 1-3/4"

2-3/4" Extended Lip T-Strike

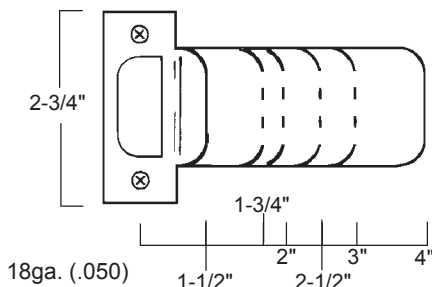

Stock No.	Finishes	Size
DJ-ETS102	605, 609, 630	2-3/4" x 2"
DJ-ETS103	605, 609, 630	2-3/4" x 3"
DJ-ETS104	605, 609, 630	2-3/4" x 4"
DJ-ETS115	605, 609, 630	2-3/4" x 1-1/2"
DJ-ETS125	605, 609, 630	2-3/4" x 2-1/2"
DJ-ETS175	605, 609, 630	2-3/4" x 1-3/4"

Security Strikes - display packed



DJ-2SDS

For Deadbolt



DJ-2SS

For Key-in-knob



DJ-2SDS 8

Super strike for deadbolt

Stock No.	Finish	Size
DJ-2SDS BP	Steel Brass Plated	4-7/8" x 1-1/4"
DJ-2SDS SL	Steel Silver Coated	4-7/8" x 1-1/4"
DJ-2SS BP	Steel Brass Plated	4-7/8" x 1-1/4"
DJ-2SS SL	Steel Silver Coated	4-7/8" x 1-1/4"
DJ-2SDS 8 BP	Steel Brass Plated	8" x 1-3/8"
DJ-2SDS 8 SL	Steel Silver Coated	8" x 1-3/8"

13 ga. (.095). Supplied with four 3" screws for extra security.

©ZIPF LOCK COMPANY

STRIKES

DON-JO

STRIKES

SERIES 8 STRIKE

Single Hole Version

Single hole version designed to work with key-in-knob or dead-bolt.

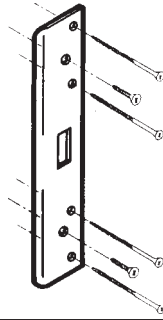

Stock No.

DJ-FL208N BP

DJ-FL208W BP

DJ-FL208W SL

DJ-FL208W WH

Finish

Brass Plated

Brass Plated

Silver Coated

White Coated

Size

8" X 1-3/8"

8" X 1-3/4"

8" X 1-3/4"

8" X 1-3/4"

SERIES 12 STRIKE

Single Hole Version

Single hole version designed to work with key-in-knob or dead-bolt.

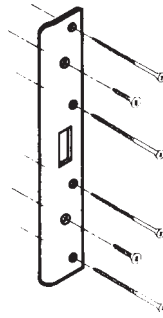

Stock No.

DJ-FL212N BP

DJ-FL212W BP

DJ-FL212W SL

DJ-FL212W WH

Finish

Brass Plated

Brass Plated

Silver Coated

White Coated

Size

12" X 1-3/8"

12" X 1-3/4"

12" X 1-3/4"

12" X 1-3/4"

Double Hole Version

Double hole version designed to accommodate both 3-5/8" and 4" centered locksets.

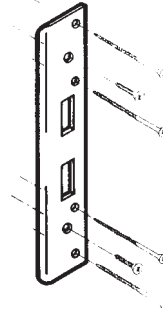

Stock No.

DJ-FL212N4 BP

DJ-FL212W4 BP

DJ-FL212W4 SL

DJ-FL212W4 WH

Finish

Brass Plated

Brass Plated

Silver Coated

White Coated

Size

12" X 1-3/8"

12" X 1-3/4"

12" X 1-3/4"

12" X 1-3/4"

Double Hole Version

Double hole version designed to accommodate 6" center holes.

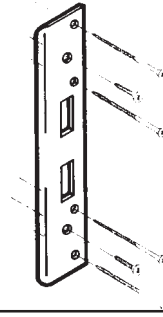

Stock No.

DJ-FL212N6 BP

DJ-FL212N6 SL

DJ-FL212W6 BP

DJ-FL212W6 SL

DJ-FL212W6 WH

Finish

Brass Plated

Silver Coated

Brass Plated

Silver Coated

White Coated

Size

12" X 1-3/8"

12" X 1-3/8"

12" X 1-3/4"

12" X 1-3/4"

12" X 1-3/4"

SERIES 18 STRIKE

Single Hole Version

Single hole version designed to work with key-in-knob or dead-bolt.

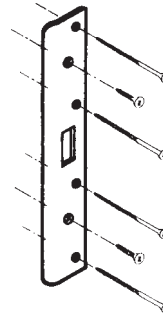

Stock No.

DJ-AST21341 BP

DJ-AST21341 SL

DJ-AST21381 BP

Finish

Brass Plated

Silver Coated

Brass Plated

Size

18" X 1-3/4"

18" X 1-3/4"

18" X 1-3/8"

STRIKES

DON-JO

STRIKES

SERIES 18 STRIKE

Double Hole Version

Double hole version designed to accommodate both 3-5/8" and 4" centered locksets.

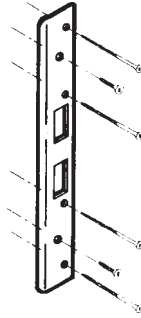

<u>Stock No.</u>	<u>Finish</u>	<u>Size</u>
DJ-AST21342 BP	Brass Plated	18" X 1-3/4"
DJ-AST21342 SL	Silver Coated	18" X 1-3/4"
DJ-AST21382 BP	Brass Plated	18" X 1-3/8"

Double Hole Version

Double hole version designed to accommodate 6" center holes.

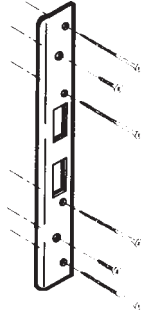

<u>Stock No.</u>	<u>Finish</u>	<u>Size</u>
DJ-AST21346 BP	Brass Plated	18" X 1-3/4"
DJ-AST21346 SL	Silver Coated	18" X 1-3/4"
DJ-AST21346 WH	White Coated	18" X 1-3/4"
DJ-AST21386 BP	Brass Plated	18" X 1-3/8"

Mortise Lock Version

Mortise hole version with "universal" center hole.

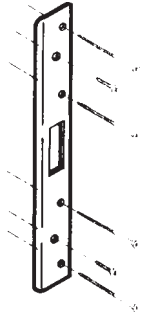

<u>Stock No.</u>	<u>Finish</u>	<u>Size</u>
DJ-AST2134M BP	Brass Plated	18" X 1-3/4"
DJ-AST2134M SL	Silver Coated	18" X 1-3/4"

ADJUSTABLE SECURITY STRIKE

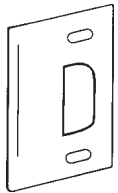

DJ-A2SS



DJ-A2SDS

<u>Stock No.</u>	<u>Size</u>	<u>Description</u>	<u>Finish</u>
DJ-A2SS BP	3-3/8" X 1-3/4"	Key in knob strike	Steel Brass Plated
DJ-A2SS SL	3-3/8" X 1-3/4"	Key in knob strike	Steel Silver Coated
DJ-A2SDS BP	3-3/8" X 1-1/4"	Deadbolt strike	Steel Brass Plated
DJ-A2SDS SL	3-3/8" X 1-1/4"	Deadbolt strike	Steel Silver Coated

STRIKES

STRIKES FOR:

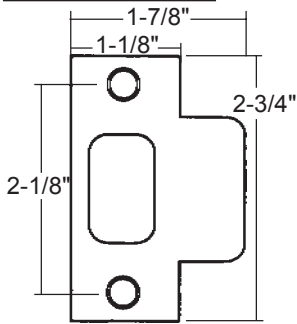

KW-83028 US-3, 26D
Metal Jamb Strike (TMS)
Not available on deadlocks

Kwikset
UltraMax
Signatures

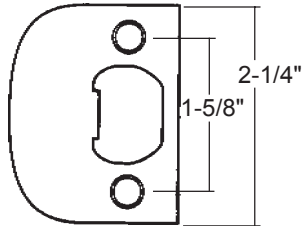

KW-83437
US-3, 5, 10B, 15, 15A, 26D
Standard Lockset Strike

Kwikset
Maximum
SECURITY

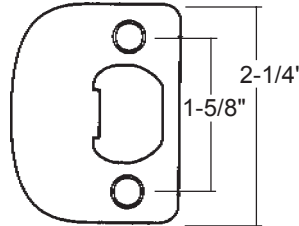

KW-83796
US-3, 5, 10B, 15, 15A, 26D
1/4" Radius Strike (RCS-4)

Kwikset
Security

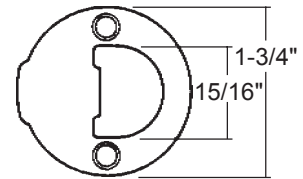

KW-83929 US-3, 5
Full round 1-3/4" metal jamb
strike (includes metal and
wood screws)

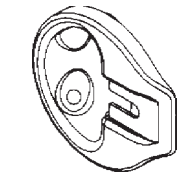
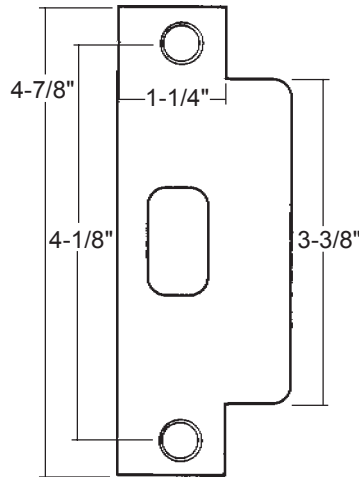

KW-80318 US-3, 5, 26D
Full round adjustable strike.

KW-83846 US-3, 26D
Metal Jamb Strike
1-1/4" x 4-7/8" ANSI
Not available on deadlocks

FINISHES:

US-3 (605)	Polished Brass
US-LO3 (605E)	Polished Brass-Life
US-5 (609)	Antique Brass
US-10B (613)	Oil Rubbed Bronze
US-15(619)	Satin Nickel
US-15A (620)	Antique Nickel
US-26 (625)	Polished Chrome
US-26D (626)	Satin Chrome

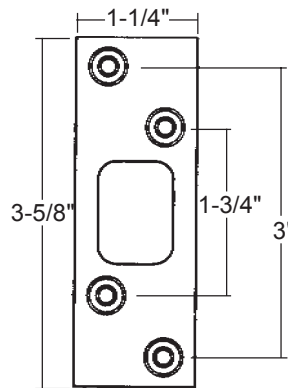

KW-83222 US-3, 26D
780, 785, 970, 975, 980, 985

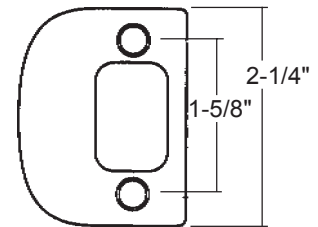

KW-84638 US-3, 5, 26D
Deadbolt strike with lip

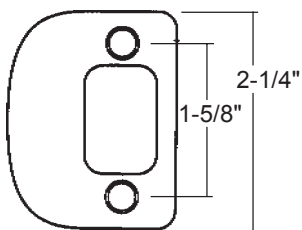

KW-85303 US-10B, 15, 15A
Deadbolt strike with lip. 1/4"
radius corners.

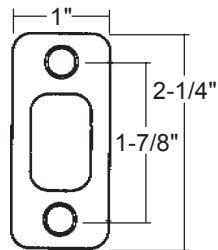

KW-85063
US-3, 5, 15, 15A, 26D
660 Series Deadlock Strike
Round corner strike

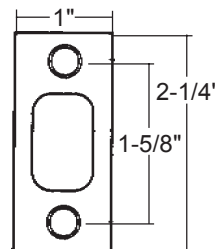

KW-85072 US-3, 5, 26D
660 Series Deadlock Strike
Square corner strike

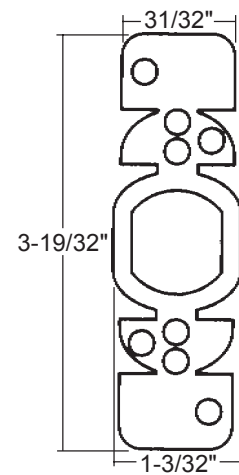

KW-81640 Strike Box
Plastic door jamb deadbolt
strike insert for cleaner
installation

STRIKES



WELDABLE GATE BOXES

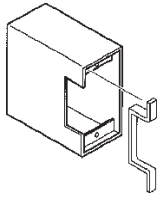

KD-K-BXES1

For installing Trine 005 and Rofu 1106 electric strikes.

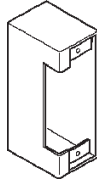

KD-K-BXES2

For installing Rofu 1402, 1702 and 3402 electric strikes. Also Rutherford 7 Series.

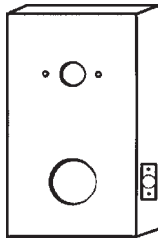

KD-K-BXSIM

For installing Simplex/Unican 1000 Series.



Stock No.

MAG-747-3

Finish

Brass

The ONLY strike to use when installing deadbolts.

- For use with any deadbolt. (Box is 1-5/8" high x 3/4" wide x 1-1/4" deep).
- Standard ASA 1-1/4" x 4-7/8".
- One piece construction.
- Secured by 4—2" long hardened screws.
- 2 screws at bottom of box are offset and installed at a 25° angle allowing screws to enter the stud closer to the center for maximum holding strength. Prevents bolts from being pushed in with punch.
- Box made of heavy 16 gauge steel.

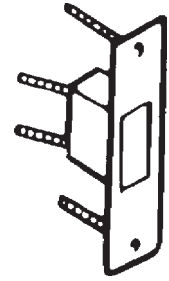

ADJUST-A-STRIKE

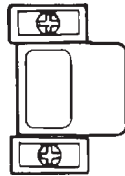
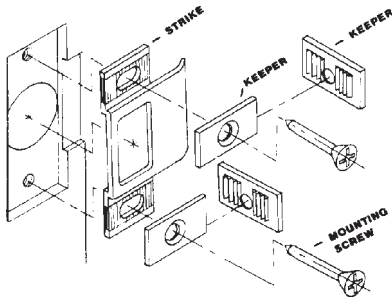

Stock No.

MAG-450-B

Finish

Brass

2-3/4" x 1-1/4" Lip Strike

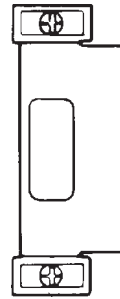

Stock No.

MAG-454-C

Finish

Chrome

4-7/8" x 1-1/4" Lip Strike For Metal Frame

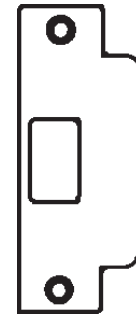

Stock No.

MAG-721-B

Finish

Brass

Large Lip Strike with 2" screws. (4-7/8" x 1-1/4").

This strike eliminates door rattle, bind on lock bolt, and provides for a snug fit against weather-strip for energy conservation.

progressive

SECURITY STRIKES

- Heavy gauge steel.
- Brass plated.
- Supplied with 1-1/2" screws.
- Individual poly bagged.



PG-9620

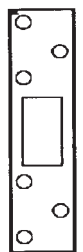

PG-9630

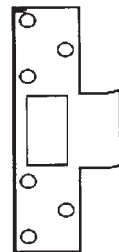

PG-9640

Stock No.

PG-9620

Size

10" x 1-1/4"

PG-9630

5-7/8" x 1-1/8"

PG-9640

5-7/8" x 1-1/8"

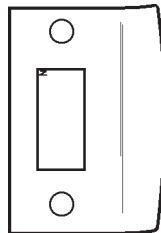

\$PG-73

Passage Strike-Curved Lip Brass Plated

\$-Discontinued. Call for closeout prices



FLUSH BOLT STRIKE—

Dust Proof Strikes - Threshold Only

- Designed for use with the bottom bolt of the Ives extension flush bolts on non-fire rated openings. For installation in thresholds up to 1/4" thick.
- 3/4" diameter plunger accepts up to 5/8" diameter round bolts or 1/2" square bolts.
- Can be locked in up position by rotating plunger with screwdriver or coin. Eliminates trapping of spiked heels.
- Made from polished wrought brass.
- Dimensions:
Faceplate: 1-3/8" Diameter
Body: 1-61/64" Overall Depth,
Fits Hole 1-1/16" in Dia.

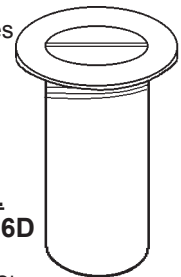

Stock No.

IV-DP3 26D

Finish:

26D Satin Chrome

STRIKES

STRIKES



SC-10-001

605, 612, 613, 626
Standard Strike

SIZE: 2-3/4" x 1-1/8" x 3/32"



SC-10-025

605, 612, 613, 626
Strike for ANSI preparation
SIZE: 4-7/8" x 1-1/4" x 3/32"

SCHLAGE

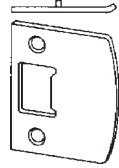

SC-10-026

605, 626
Full Lip Standard Strike



SC-10-058

605

Circular, adjustable
1-3/4" diameter
deadlatch strike

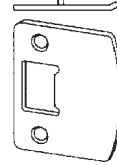

SC-10-027

605, 626
1/4" Radius Rounded
Corner Full Lip Strike

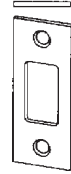

SC-10-094

605, 626
BC160, B360, BR260
Standard Strike
Square Corner

Finishes:

605 Bright Brass

612 Satin Bronze

613 Oil Rubbed Bronze

626 Satin Chrome