

CAM LOCKS

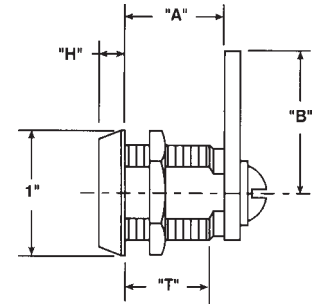

DOUBLE BITTED CAM LOCKS

- Eleven crisscross blade tumbler plug in 3/4" diameter.
- Die Cast barrel with two flats—5/8" across.
- Key and cam rotation 90° from locked (12 O'clock) to unlocked (3 O'clock) position with keypull in locked position only.
- Straight cam furnished is 1/8" thick x 3/4" wide.
- Standard finish: Polished Nickel.
- Two keys furnished per lock.

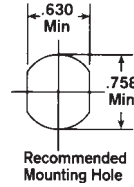

1801 Series

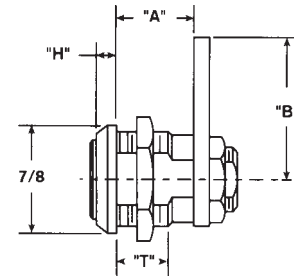

3186, 3205 Series

Stock No.	A	B	H	I	Keyed Alike Numbers Available
C1801	13/16"	1-1/8"	13/64"	11/16"	2001 (No KD)
C1802	1-1/16"	1-1/8"	13/64"	15/16"	2001 (No KD)
C1804	1-1/2"	1-1/8"	13/64"	1-13/32"	2001 (No KD)
C3186	5/8"	1-1/8"	5/32"	13/32"	2001, 2007
C3205	7/16"	1-1/8"	13/64"	15/64"	2001, 2007

Most Locks available **KV***-Keyed Different or **KA**-Keyed Alike.

Specify KD or KA

*KV indicates the majority of the quantity of locks will be keyed different. A lesser quantity will potentially be keyed alike to one or more key numbers. We can not guarantee that we can ship keyed DIFFERENT locks.

ACE II® 7 PIN TUMBLER CAM LOCKS

- All brass construction.
- Patented Ace II® assembly.
- Center plug contains anti-drill pin for added security.
- Furnished with straight locking cams which can be mounted vertically or horizontally and also a 1/4" offset cam. Cams are 1/8" thick x 3/4" wide..
- Standard finish: Polished Nickel.
- Two keys furnished per lock.

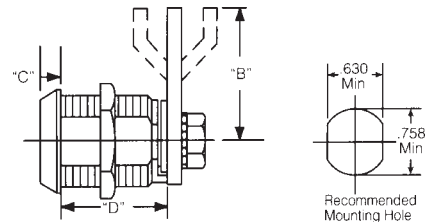

Stock No.	B	C	D	Keyed Alike Numbers Available
C4152	1-1/8"	13/64"	15/16"	PL505, PL910, 6022*
C4153	1-1/8"	1/4"	11/16"	PL505, PL910, 6234, 6030*
C4160	1-1/8"	13/64"	1-3/32"	6234, PL960*

*These keyed alike numbers are discontinued—limited supply.

Most Locks available **KD**-Keyed Different or **KA**-Keyed Alike. **Specify KD or KA**

Key rotation/Removal is determined by the STOP CAM you select and how it is positioned. A) 180° clockwise rotation-key removal at 12 O'clock; B) 180° counter clockwise rotation-key removal at 12 O'clock; C) 90° clockwise rotation-key removal at 12 & 3 O'clock; D) 90° counter clockwise rotation-key removal at 12 & 9 O'clock;

©ZIPF LOCK COMPANY

CAM LOCKS



1000 SERIES HIGH SECURITY GEM CIRCULAR K137 KEYWAY

- 7 pin tumbler.
- Multi-function.
- Standard finish: Nickel Plated.
- Two keys furnished per lock.

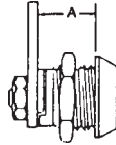

Contains:	
Lock	90° Stop Washer
Wonder Washer	Straight Cam
Spur Washer	1/4" Bent Cam
3/4" Nut	Cam hole adapter
180° Stop Washer	Screw

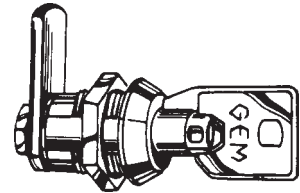

Stock No.	A	Keyed Alike Numbers Available
MFW-1038	1/2"	27379, 27380, 27381, 27382, 27383, 27384, 27385
MFW-1058	23/32"	27379, 27380, 27381, 27382, 27383, 27384, 27385
MFW-1078	15/16"	27379, 27380, 27381, 27382, 27383, 27384, 27385
MFW-1118	1-5/32"	27379, 27380, 27381, 27382, 27383, 27384, 27385
MFW-1148	1-1/2"	27379, 27380, 27381, 27382, 27383, 27384, 27385

Most Locks available **KD**-Keyed Different or **KA**-Keyed Alike. **Specify KD or KA**

Keyed Different— Locks ordered KD will be supplied with random keying. Some duplication of codes is possible.

23000 SERIES CAM LOCKS SINGLE BITTED

- Single bitted.
- Universal Keyway—K54G. (See next page)
- Multi-function
- Finish: Stainless Steel or brass.
- Two keys furnished per lock.

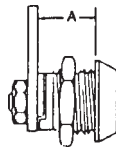

Contains:	
Lock	90° Stop Washer
Wonder Washer	Straight Cam
Spur Washer	1/4" Bent Cam
3/4" Nut	Spline Fillers
180° Stop Washer	Screw

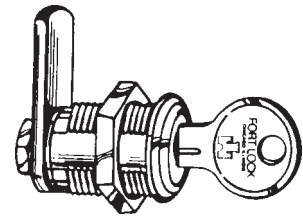

STAINLESS STEEL FINISH

Stock No.	A	Keyed Alike Numbers Available
MFW-23038	7/16"	217, 221, 224, 237, 238
MFW-23058	5/8"	217, 221, 224, 237, 238
MFW-23078	7/8"	217, 221, 224, 237, 238
MFW-23118	1-1/8"	217, 221, 224, 237, 238
MFW-23138	1-3/8"	217, 221, 224, 237, 238
MFW-23168	1-3/4"	217, 221, 224, 237, 238

BRASS FINISH

Stock No.	A	Keyed Alike Numbers Available
MFW-23038B	7/16"	217, 221
MFW-23058B	5/8"	217, 221
MFW-23078B	7/8"	217, 221
MFW-23118B	1-1/8"	217, 221
MFW-23138B	1-3/8"	217, 221
MFW-23168B	1-3/4"	217, 221

Most Locks available **KD**-Keyed Different or **KA**-Keyed Alike. **Specify KD or KA**

Keyed Different— Locks ordered KD will be supplied with random keying. Some duplication of codes is possible.

2" STRAIGHT CAMS

Stock No.	"A"	For
SF3200 2"	2"	Flat Lock
SG3200 2"	2"	Gem Lock

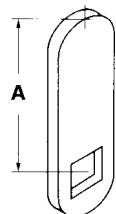

**Need a COMPX product not in our catalog??
Just give us a call with your needs !!**



©ZIPF LOCK COMPANY

CAM LOCKS



29000 SERIES HIGH SECURITY DOUBLE BITTED CAM LOCKS

- Double Bitted—5 tumblers.
- Keyway: K775
- Multi-function.
- Standard finish: Stainless Steel.
- Two keys furnished per lock.

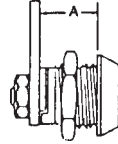

Contains:	
Lock	90° Stop Washer
Wonder Washer	Straight Cam
Spur Washer	1/4" Bent Cam
3/4" Nut	Spline Fillers
180° Stop Washer	Screw

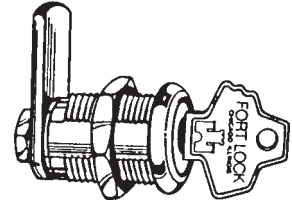

Stock No.	A	Keyed Alike Numbers Available
MFW-29058	5/8"	D3012, D3045, D3059, D3085, D3165
MFW-29078	7/8"	D3012, D3045, D3059, D3085, D3165
MFW-29118	1-1/8"	D3012, D3045, D3059, D3085, D3165
MFW-29138	1-3/8"	D3012, D3045, D3059, D3085, D3165

"Floating" tumblers-cylinder turns slightly and wedges tumblers into a secondary double locked position if picking is attempted. Key will realign tumblers when used.

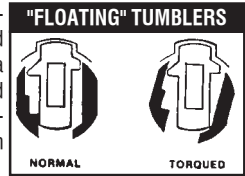

Most Locks available **KD**-Keyed Different or **KA**-Keyed Alike. **Specify KD or KA**

Keyed Different— Locks ordered KD will be supplied with random keying. Some duplication of codes is possible.

The Concept of Multi-Function:

The concept of Multi-Function is to make one bag of components available to produce many different functioning locks (up to 6 different functions in Fort's single bitted bag). This enables the locksmith to carry fewer locks in inventory while still have complete stock on hand. Multi-Function bagged cam locks include Fort's patented Wonder Washer, which allows for installation into either wood or metal without the use of a double "D" punch.

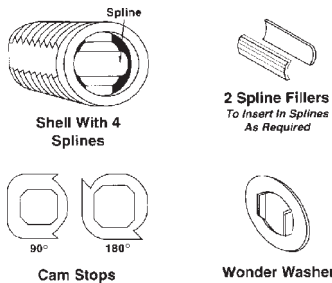

LOCKS PROVIDED WITH PARTS FOR SIX DIFFERENT FUNCTIONS				
Function	Key Rotation	Key Removeable at:	Parts Used	
			Cam Stop	Spline Filler Placed at:
1	12-3 CW	12	90° RT	3:00 & 9:00
2	12-3 CW	12, 3	90° RT	—
3	12-6 CW	12, 6	180° RT	3:00 & 9:00
4	12-9 CCW	12	90° LFT	9:00 & 3:00
5	12-9 CCW	12, 9	90° LFT	—
6	12-9 CCW	12, 6	180° LFT	9:00 & 3:00

UNIVERSAL KEYING MATRIX

Fort's 23000 series cam locks are designed with the Universal Keyway which accepts many other manufacturers' key blanks and will operate with their key code systems. (See chart at right)

This is important when you have another manufacturer's locking system in the field and you wish to build onto that existing system by adding locks made by Fort Lock and still use the same existing keys.

MFG.	Key Code	MFG.	Key Code	MFG.	Key Code
All-Lock	PK502-999	LLMK	ALxxx	Hurd	LL201H-LL225H
CCL	AMxxx codes	ESP	ES101-204		LL201H-LL225H ^s
Chicago	FAB24		SL342		2077-2099 ^s
	LL226-LL275		UC380		2051-2101
	W1000-W1050 ^E	Hudson	HL-201-400	Ilco	GH067
	W1000-		HC714-840	Lori	603
W1050 ^{ES}	LL61-LL139		MM750-999	National	EB1-240
	LL61-LL139 ^s	Hurd	HL959		C001A-633A
	LL331		2001-2050		D127A
	1250-1499		2001-2050 ^s		

^E Even numbers
^s Sears

CAM LOCKS

PIN TUMBLER CYLINDER CAM LOCKS—BRASS CONSTRUCTION



Cam Dimensions

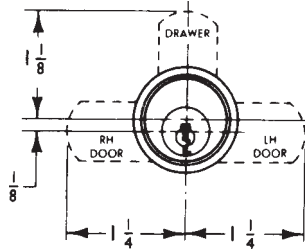

Through the use of a shifter, the 360° key turn turns the cam 90° in either direction. Actual application determines which cam position is the locked position. Each lock is furnished with an alternate cam for opposite cam turn

Applications: solid lines show locked position of cam	Position of shifter on back of lock	Applications: solid lines show locked position of cam	Position of shifter on back of lock

**LIPPED/
OVERLAY**
NL-C8103
NL-C8109

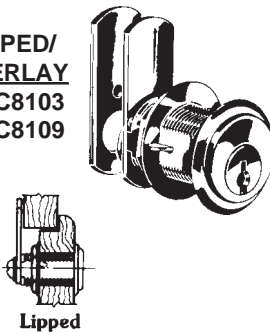

APPLICATION—For drawers, RH or LH doors. NL-C8103 and NL-C8109 are for lipped or overlay construction. For overlay application, the combined thickness of front and frame cannot exceed the cylinder length. Also see overlay detail below. The other locks are for flush applications.

OPERATION—90° cam turn, key removable in both locked and unlocked positions.

KEYING—Will key together with all other pin tumbler locks using D4291 key blank except NL-C8700 series mail box locks. See table for available keying.

KEY BLANK—D4291.

FINISH—4-Satin Brass, 26D-Dull Chrome (Brushed)

PACKAGING—Supplied with two keys, trim washer, spur washer for wood, mounting nut and two cams.

FLUSH
NL-C8106
NL-C8108

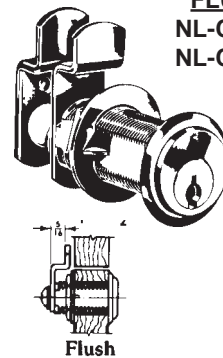

The NL-C8102, is a Multi-Functional Pin Tumbler cam lock with a 1-1/16" cylinder length. The lock is packaged with four (4) cams, two straight and two double formed. This allows the lock to be used for multiple applications for either drawer or right hand/left hand with lipped or overlay construction.

<u>Stock No.</u>	<u>Type of Mounting</u>	<u>Cylinder Length</u>	<u>Maximum Material Thickness</u>	<u>Finishes</u>	<u>Keyed Alike Numbers Available</u>
NL-C8102	Flush	1-1/16"	3/4"	4, 26D	107, 915
NL-C8103	Lipped/Overlay	1-3/16"	7/8"	4, 26D	4-107, 26D-101, 107, 915
NL-C8106	Flush	1-7/16"	1-1/8"	4, 26D	4-107, 26D-107, 915
NL-C8108	Flush	1-3/4"	1-3/8"	4, 26D	107, 915
NL-C8109	Lipped/Overlay	1-3/4"	1-1/2"	4, 26D	4-107, 26D-107, 915

Most Locks available **KD**-Keyed Different or **KA**-Keyed Alike. *Specify KD or KA*

Combi-Cam™

The Best Combined Cam Lock on the Market!

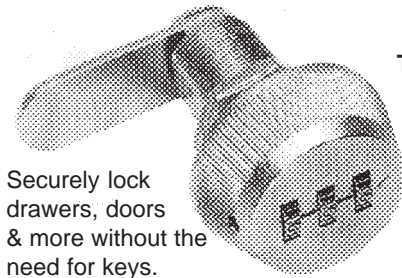

Securely lock drawers, doors & more without the need for keys.

Cam Lock—(Chrome)

Stock No. **Length**

CC-7850L 1-1/8"

CC-7850M 7/8"

CC-7850S 5/8"

No Keys to Hassle With!!

The Combi-Cam is a secure solid metal cam lock with 1,000 possible combinations. Best of all, unlike the competition, it requires no expensive kits nor the arduous task of entirely taking apart the lock replacing disks!

Changing the combination is simple. With the lock set on the opening combination, push in the reset button while setting the new combination. IT IS THAT EASY!

Great product for when keys are a hassle or when frequent lock changes are needed!!

Accessories—

Stock No. **Description**

CC-7850-FP Finger Pull

CC-7850-OC 2" offset cam

©ZIPF LOCK COMPANY

CAM LOCKS

DISC TUMBER CYLINDER CAM LOCKS



Mounting Holes for all Cam Locks

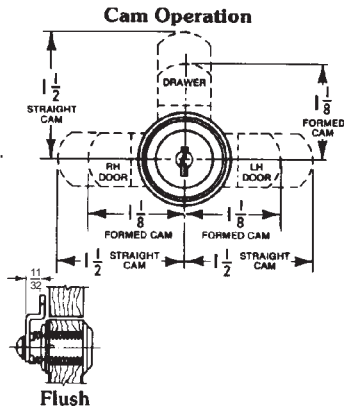
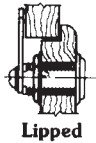
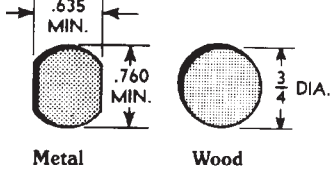

APPLICATION—For drawers, RH or LH doors with lipped / overlay construction (straight cam) or flush construction (formed cam). For overlay application, the combined thickness of front and frame cannot exceed the cylinder length. Also see overlay detail below.

OPERATION—90° cam turn on all locks. Key removable in both locked and unlocked positions.

KEYING—Will key together with all other disc tumbler locks using D8785 key blank. Available keyed alike or keyed different. See keyed alike numbers below.

KEY BLANK—D8785

FINISH—3-Bright Brass, 4G-Antique Brass, 14A-Bright Nickel

PACKAGING—Supplied with two keys, trim washer, spur washer for wood, mounting nut and two cams.

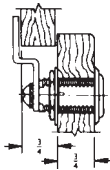

Stock No

NL-C7014-2C Cam

The NL-C8053 lock using the NL-C7014-2C cam (order separately) accommodates overlay construction using a 3/4" thick front and 3/4" thick frame. 1-5/8" long.

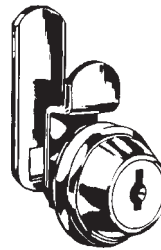

NL-C8051

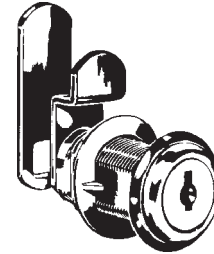

NL-C8052, NL-C8053
NL-C8054, NL-C8055

Locks furnished with straight cam assembled.

Stock#	Type of Mounting	Cylinder Length	Maximum Material Thickness	Finishes	Keyed Alike Numbers Available
NL-C8051		7/16"	7/64"	3, 14A	See chart below
NL-C8052	Lipped/Overlay	5/8"	15/64"	3, 14A	See chart below
NL-C8053	or	1-3/16"	7/8"	3, 4G, 14A	See chart below
NL-C8054	Flush	15/16"	5/8"	3, 4G, 14A	See chart below
NL-C8055		1-7/16"	1-1/8"	3, 14A	See chart below

Most Locks available **KD**-Keyed Different or **KA**-Keyed Alike. **Specify KD or KA**

KEYED ALIKE NUMBERS AVAILABLE:

- NL-C8051-3 C413A
- NL-C8051-14A C346A, C413A, C415A, C642A
- NL-C8052-3 C346A, C413A, C415A
- NL-C8052-14A C346A, C413A, C415A, C420A, C642A
- NL-C8053-3 C346A, C390A, C413A, C415A, C642A
- NL-C8053-4G C346A, C390A, C415A, C642A
- NL-C8053-14A C346A, C390A, C413A, C415A, C420A, C642A
- NL-C8054-3 C413A, C415A
- NL-C8054-4G C413A
- NL-C8054-14A C346A, C390A, C413A, C415A, C420A, C642A
- NL-C8055-3 C346A, C390A, C413A, C415A, C420A, C642A
- NL-C8055-14A C346A, C413A, C415A, C420A, C642A

CAM LOCKS

DISC TUMBLER CYLINDER CAM LOCKS WITH FLEXAFUNCTION



Mounting Holes for all Cam Locks

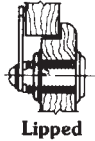
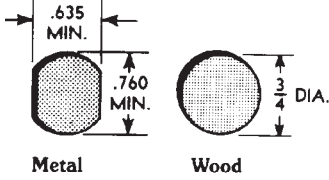

Lipped

Cam Operation

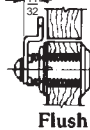
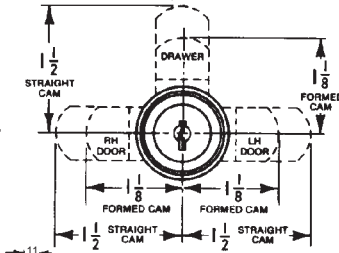

Flush

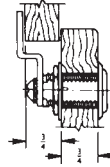

OVERLAY

Stock No

NL-C7014-2C Cam

The NL-C8073 lock using the NL-C7014-2C cam (order separately) accommodates overlay construction using a 3/4" thick front and 3/4" thick frame. 1-5/8" long.

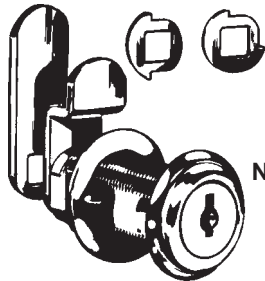

NL-C8060, NL-C8073, NL-C8075

Assembled with straight cam and 90° cam rotation

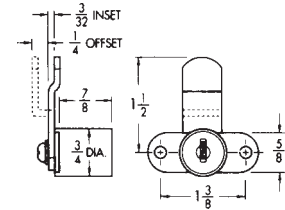
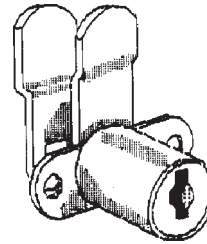

NL-C8080

Assembled for 90° cam turn

APPLICATION—For drawers, RH or LH doors with lipped /overlay construction (straight cam) or flush construction (formed cam). For overlay application, the combined thickness of front and frame cannot exceed the cylinder length. Also see overlay detail above.

OPERATION—Choice of either 90° or 180° cam turn. Key removable in both locked and unlocked positions.

KEYING—Will key together with all other disc tumbler locks using D8785 key blank. Available keyed alike or keyed different. See keyed alike numbers below.

KEY BLANK—D8785

FINISH—3-Bright Brass, 4G-Antique Brass, 14A-Bright Nickel

PACKAGING—Supplied with two keys, trim washer, spur washer for wood, mounting nut, two cams and two stop washers.

APPLICATION—For doors and drawers. Surface mounted. Requires 3/4" dia. hole for cylinder.

OPERATION—Choice of either 90° or 180° cam turn. Key removable in both locked and unlocked positions.

KEYING—Will key together with all other disc tumbler locks using D8785 key blank. Available keyed alike or keyed different. See keyed alike numbers below.

KEY BLANK—D8785

FINISH—3-Bright Brass, 4G-Antique Brass, 14A-Bright Nickel

PACKAGING—Supplied with two keys, two mounting screws, two formed cams and two stop washers. Assembled for 90° cam turn.

Stock#	Type of Mounting	Cylinder Length	Maximum Material Thickness	Finishes	Keyed Alike Numbers Available
NL-C8060	Lipped/	1-3/4"	1-7/16"	3, 4G, 14A	See chart below
NL-C8073	Overlay	1-3/16"	7/8"	3, 4G, 14A	See chart below
NL-C8075	or	1-7/16"	1-1/8"	3, 14A	See chart below
NL-C8080	Flush	7/8"	7/8"	3, 4G, 14A	See chart below

Most Locks available **KD**-Keyed Different or **KA**-Keyed Alike. *Specify KD or KA*

KEYED ALIKE NUMBERS AVAILABLE:

NL-C8060-3 C415A
 NL-C8060-4G C413A, C415A
 NL-C8060-14A C346A, C390A, C415A
 NL-C8073-3 C346A, C390A, C415A, C642A
 NL-C8073-4G C390A, C415A, C642A
 NL-C8073-14A C346A, C390A, C413A, C415A, C420A, C642A

NL-C8075-3 C390A, C413A, C415A, C420A
 NL-C8075-14A C346A, C390A, C413A, C415A, C420A, C642A
 NL-C8080-3 C390A
 NL-C8080-4G C413A
 NL-C8080-14A C346A

CHEST, CUPBOARD & DRAWER LOCKS

SPECIAL PURPOSE DRAWER & DOOR LOCK

CompX
CHICAGO

- Six disc tumbler plug in 3/4" diameter.
- Die Cast barrel with two flats—21/32" across.
- Key and cam rotation 90° from locked (12 O'clock) to unlocked (3 O'clock) position with keypull in both positions.
- This lock designed to be used with customer's latching mechanism.
- Standard finish: Satin Nickel.
- Two keys furnished per lock.

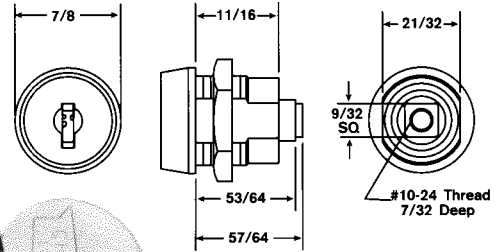
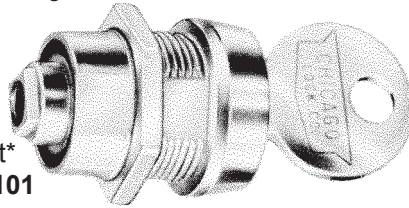

Stock No.

C17256TNH KV*

C17256TNH KA

Keying

Keyed Different*

Keyed Alike: 1101

*KV indicates the majority of the quantity of locks will be keyed different. A lesser quantity will potentially be keyed alike to one or more key numbers. We can not guarantee that we can ship keyed DIFFERENT locks.

BOLT TYPE LOCKS

- Five Disc tumbler.
- Removable plug feature.
- Steel locking bolt.
- Furnished with two keys per lock.

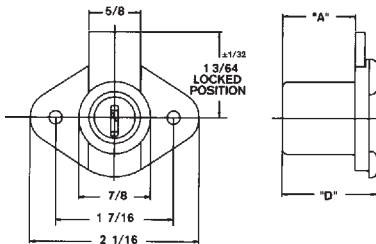

C1968

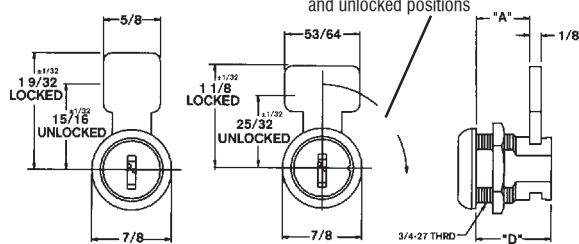

C1975

C1974

<u>Stock No.</u>	<u>A</u>	<u>D</u>	<u>Finish</u>	<u>Keyed Alike Numbers Available</u>
C1968	57/64"	1-5/32"	Brushed Brass	1289, 1454
C1974	19/32"	27/32"	Satin Chrome	1289, 1454
C1975	21/32"	57/64"	Satin Chrome	1289, 1454

Available KV-Keyed Different or KA-Keyed Alike. **Specify KV or KA**

*KV indicates the majority of the quantity of locks will be keyed different. A lesser quantity will potentially be keyed alike to one or more key numbers. We can not guarantee that we can ship keyed DIFFERENT locks.

**Need a Chicago item not shown??
Call us today !!**

CHEST, CUPBOARD & DRAWER LOCKS

KD-Keyed Different
KA-Keyed Alike, Specify #



Discontinued. Call for closeout prices.

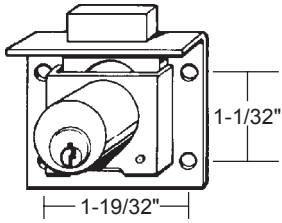

Pin Tumbler
0666 7/8 KA
KA# 4T37526

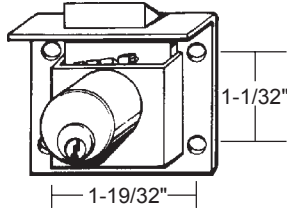

Pin Tumbler
0666 1/2-7/8 KA
KA# 4T50316

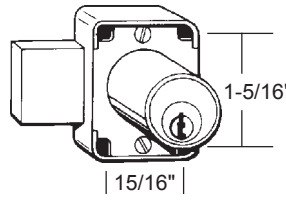

Pin Tumbler
0737 7/8 KA
KA# B4R37539

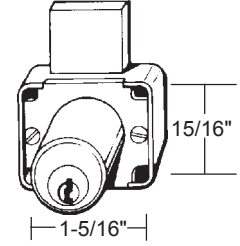

Pin Tumbler
0738 7/8 KD
0738 7/8 KA
KA# 4T27543

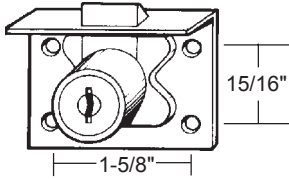

Disc Tumbler
02065 1/2-7/8" KD
02065 1/2-7/8" KA
KA# CAT65

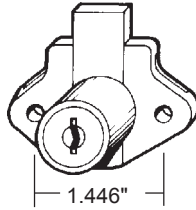

Disc Tumbler
02066 3/4" KD
02066 3/4" KA
KA# AUE1, CAT30

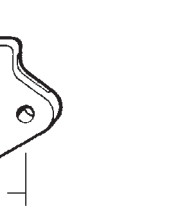

Disc Tumbler
02066 7/8" KD
02066 7/8" KA
KA# CAT9

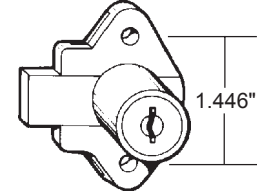

Disc Tumbler
02067 3/4" KD

Disc Tumbler
02067 7/8" KD

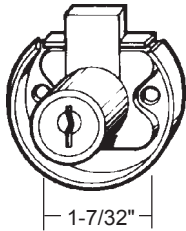

Disc Tumbler
02068 7/8" Deadbolt
02068 1/2-7/8" Latchbolt
KD only

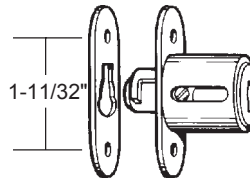

Disc Tumbler
02069 7/8" KD
02069 7/8" KA
KA# CAT30

Stock No.	Size	Material	Backset	For Wood	Finish	Keyway
0666 7/8"	2"x1-5/8"	Brass	7/8"	7/8"	US-4	8618C-R1
0666 1/2-7/8"	2"x1-5/8"	Brass	7/8"	7/8"	US-4	8618C-R1
0737 7/8"	1-1/4"x1-5/8"	Brass ^A	5/8"	7/8"	US-4	8618C-R1
0738 7/8"	1-5/8"x1-1/4"	Brass ^A	5/8"	7/8"	US-4	8618C-R1
02065 1/2-7/8"	2-1/64"x1-9/16"	Die Cast ^B	3/4"	7/8"	US-4	5865JVR
02066 3/4"	2-1/16"x1-7/16"	Die Cast ^B	3/4"	3/4"	US-4	5865JVR
02066 7/8"	2-1/16"x1-7/16"	Die Cast ^B	3/4"	7/8"	US-4, 26D	5865JVR
02067 3/4"	1-7/16"x2-1/16"	Die Cast ^B	3/4"	3/4"	US-4	5865JVR
02067 7/8"	1-7/16"x2-1/16"	Die Cast ^B	3/4"	7/8"	US-4	5865JVR
02068 7/8"	1-3/4"x1-5/8"	Die Cast ^B	3/4"	7/8"	US-4	5865JVR
02068 1/2-7/8"	1-3/4"x1-5/8"	Die Cast ^B	3/4"	7/8"	US-4	5865JVR
02069 7/8"	2"x7/8"	Brass/Cast ^C	7/8"	7/8"	US-4	5865JVR

^APressure cast case, brass cylinder

^BBrass plated steel backplate & bolt, Pressure cast cylinder

^CBrass outside cylinder, pressure cast plug

Note: CCL is being phased out. If out, please check other manufacturers in this section.

©ZIPP LOCK COMPANY

260 v1
(PL-20)

Also be sure to check "DESKS LOCK" if you cannot find it here.

CHEST, CUPBOARD & DRAWER LOCKS

23000 SERIES SINGLE BITTED DRAWER LOCKS W/UNIVERSAL KEYWAY

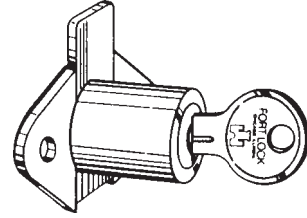

- Single bitted.
- Universal Keyway—K54G. (See next page)
- Multi-function—Latch & Deadlatch included.
- Keypull at 12:00 & 3:00.
- Finish: Brass or Stainless Steel.
- Two keys furnished per lock.

Stock No.	Finish	Hole Diameter	Keyed Alike Numbers Available
MFW-23007	Stainless Steel	7/8"	221
MFW-23007B	Brass	7/8"	217
MFW-23008B	Brass	1-1/8"	217

Available **KD**-Keyed Different or **KA**-Keyed Alike. *Specify KD or KA*

23000 SERIES MULTI-FUNCTION METAL DRAWER LOCK w/UNIVERSAL KEYWAY

- Single bitted.
- Multi-function—2 bolt throw heights.
- Bolt notched for assembled installation.
- 90° key turn to open.
- Key removable locked or unlocked.
- Removable cylinder for rekeying.
- Finish: Brass or Stainless Steel.
- Two keys furnished per lock.

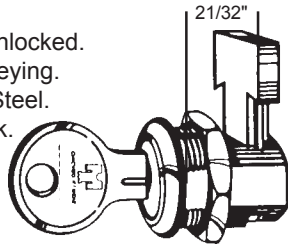

Stock No	Keying
MFW-23010 KD	Keyed Different
MFW-23010 KA	Keyed Alike—217, 221, 224, 237, 238

1000 SERIES HIGH SECURITY TUBULAR DRAWER LOCK

- 7 pin tumbler.
- 3/8" bolt throw.
- Keypulls at 12:00 & 6:00.
- 180° key turn to open
- Standard finish: Chrome Plated.
- Two keys furnished per lock.

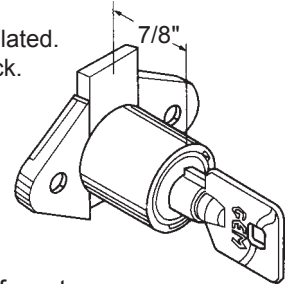

Discontinued. Call for closeout prices.

Stock No	Keying
DR-1008 KD	Keyed Different
DR-1008 KA	Keyed Alike—27379, 27380

DRAWER AND CABINET LOCKS

- Single bitted.
- Key removable at 12:00 & 6:00.
- Keyway: O1014S.
- 7/8" diameter.
- Brass finish.

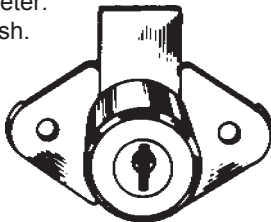

Stock No.	Barrel Length	Keyed Alike Number Available
1701-04-11	3/4"	EB78
1702-04-11	7/8"	EB8, EB72, EB78, EB92

Available **KD**-Keyed Different or **KA**-Keyed Alike. *Specify KV or KA*

BRASS WOOD DRAWER LOCKS

- Single bitted.
- Keyway: IN8.
- Brass finish.
- Two keys per lock.
- 7/8" diameter.



CONVERSION CHART		
Jet	DR0782	DR1182
Fort	MFW23007	MFW23008
CCL	02066-7/8	02066-1 1/8
Chicago	C1968	
ESP	875WD	1125WD
National	C8803	

Stock No.	Barrel Length	Keyed Alike Number Available
JT-DR0782	7/8"	330,331
JT-DR1182	1-1/8"	330,331

Available **KD**-Keyed Different or **KA**-Keyed Alike. *Specify KD or KA*

©ZIPF LOCK COMPANY

Also be sure to check "DESKS LOCK" if you cannot find it here.

CHEST, CUPBOARD & DRAWER LOCKS

PIN TUMBLER DOOR AND DRAWER LOCKS

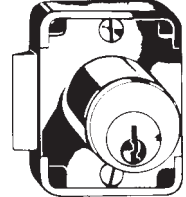
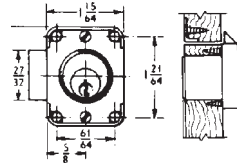
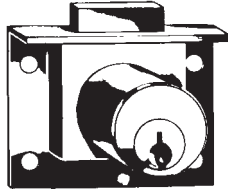
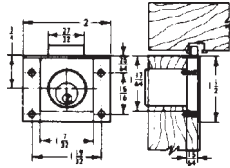
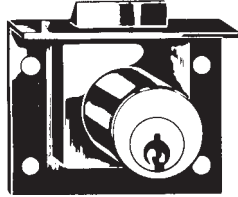

NL-C8131

NL-C8133
NL-C8135

NL-C8139

APPLICATION—For drawers. Half mortise type requires mortise for housing and 57/64" dia. hole for cylinder. NL-C8139 is surface mounted.

OPERATION—Key removable in both locked and unlocked positions except NL-C8131 and NL-C8139.

KEYING—Will key together with all other pin tumbler locks using D4291 key blank except NL-C8700 mail box locks. Available keyed different (**KD**) or keyed alike (**KA**).

KEY BLANK—D4291.

PACKAGING—Supplied with two keys, strike and mounting screws.

FINISHES—4-Satin Brass, 26D- Dull Chrome.

Stock #	Installation	Bolt Type	Cylinder Length	Bolt Travel	Keyed Alike Numbers Available
NL-C8131-4*	Drawer	Spring	7/8"	7/32"	107
NL-C8131-26D*	Drawer	Spring	7/8"	7/32"	101, 107, 915
NL-C8133-4	Drawer	Dead	7/8"	1/4"	107
NL-C8133-26D	Drawer	Dead	7/8"	1/4"	101, 107, 915
NL-C8135-26D	Drawer	Dead	1-1/8"	1/4"	101, 107
NL-C8139-26D*	Door	Spring	3/4"	7/32"	107, 915

*Key removable in locked position only.

Available **KD**-Keyed Different or **KA**-Keyed Alike. *Specify KD or KA*

PIN TUMBLER DOOR DRAWER LOCKS

APPLICATION—For center drawers of desks. Fits special piercing of drawer front and seldedge (see drawing). Reinforced insertable dead bolt. Metal drawer, 1/4" Max. material thickness.

OPERATION—Key removable in both locked and unlocked positions.

KEYING—Will key together with all other pin tumbler locks using D4291 key blank except NL-C8700 mail box locks. Available keyed different (**KD**) or keyed alike (**KA**).

KEY BLANK—D4291.

PACKAGING—Supplied with two keys and mounting nut.

FINISHES—26D- Dull Chrome.

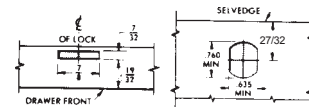

Mounting Holes



Stock #	Mounting or Installation	Bolt Type	Cylinder Length	Bolt Travel	Keyed Alike Number Available
NL-C8137-26D	Drawer	Reinforced, Insertable Dead Bolt	19/32"	7/16"	107, 915

Available **KD**-Keyed Different or **KA**-Keyed Alike. *Specify KD or KA*

CHEST, CUPBOARD & DRAWER LOCKS

PIN TUMBLER DOOR AND DRAWER LOCKS



APPLICATION—For drawers, RH or LH doors. Surface mounted. Requires 57/64" dia. hole for cylinder.

OPERATION—Key removable in both locked and unlocked positions.

KEYING—Will key together with all other pin tumbler locks using D4291 key blank except NL-C8700 mail box locks. Available keyed different (**KD**) or keyed alike (**KA**).

KEY BLANK—D4291.

PACKAGING—Supplied with two keys, strike and mounting screws.

FINISHES—4-Satin Brass, 4G-Antique Brass, 26D- Dull Chrome.

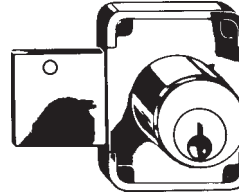
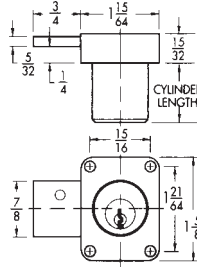

NL-C8173, NL-C8174, NL-C8175

"The Advantage Plus"

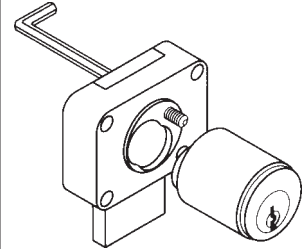

The PLUS feature allows you to remove the cylinder from these pin tumbler box locks while the lock remains in place. Simply use a 5/64" allen wrench from the back.

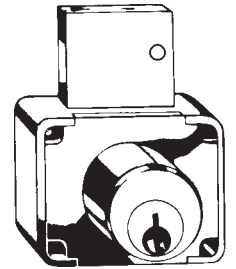
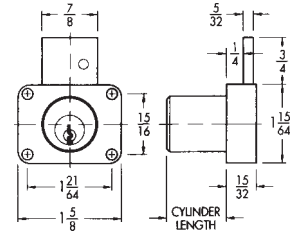

NL-C8177, NL-C8178, NL-C8179

Stock No.	Installation	Bolt Type	Cylinder Length	Bolt Travel	Keyed Alike Numbers Available
NL-C8173-4	Door	Dead	7/8"	3/4"	915
NL-C8173-4G	Door	Dead	7/8"	3/4"	915
NL-C8173-26D	Door	Dead	7/8"	3/4"	107, 915
NL-C8174-26D	Door	Dead	1-1/8"	3/4"	107
NL-C8175-26D	Door	Dead	1-3/8"	3/4"	107, 915
NL-C8177-26D	Drawer	Dead	1-1/8"	3/4"	107
NL-C8178-4	Drawer	Dead	7/8"	3/4"	107
NL-C8178-26D	Drawer	Dead	7/8"	3/4"	103, 107, 915
NL-C8179-4	Drawer	Dead	1-3/8"	3/4"	107
NL-C8179-26D	Drawer	Dead	1-3/8"	3/4"	107, 915

Available **KD**-Keyed Different or **KA**-Keyed Alike. *Specify KD or KA*

PIN TUMBLER DRAWER LOCKS

APPLICATION—For drawers. Surface mounted. Requires 57/64" dia. hole for cylinder.

OPERATION—Key removable in both locked and unlocked positions.

KEYING—Will key together with all other pin tumbler locks using D4291 key blank except NL-C8700 mail box locks. Available keyed different (**KD**) or keyed alike (**KA**).

KEY BLANK—D4291.

PACKAGING—Supplied with two keys and mounting screws.

FINISHES—4-Satin Brass, 26D- Dull Chrome.

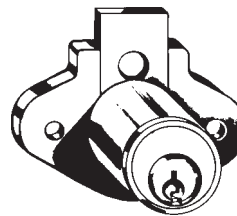

NL-C8163

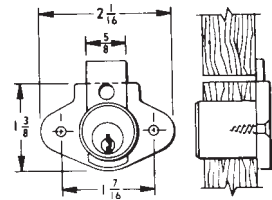

Stock No.	Installation	Bolt Type	Cylinder Length	Bolt Travel	Keyed Alike Number Avail.
NL-C8163-4	Drawer	Dead	15/16"	11/32"	101, 103, 107
NL-C8163-26D	Drawer	Dead	15/16"	11/32"	101, 915

Available **KD**-Keyed Different or **KA**-Keyed Alike. *Specify KD or KA*

"THE ADVANTAGE PLUS" NL-C8163 locks feature easy removal of cylinder from lock housing while lock remains in place. Bolt has access hole for cylinder retention screw at back of lock.

Stock No.

NL-C7163-2C Special Order 3" extension bolt for NL-C8163. Can be cut to required length. 20 per package.

©ZIPF LOCK COMPANY

Also be sure to check "DESKS LOCK" if you cannot find it here.

CHEST, CUPBOARD & DRAWER LOCKS

PIN TUMBLER DRAWER LOCKS



APPLICATION—Replacement lock housing and cylinder for drawers with 7/8" thick fronts. Half mortise design.

OPERATION—Key removable in both locked and unlocked positions. Interchangeable cylinders are attached or removed through the use of a special key at back of lock.

KEYING—Keyed different (**KD**). 100 changes.

KEY BLANK—D4292 for the NL-C8160.

PACKAGING—NL-C8160 cylinder supplied with two keys. NL-C8161 lock housing supplied with cylinder removal key and mounting screws.

FINISHES—**26**-Bright Brass; **26D**- Dull Chrome.

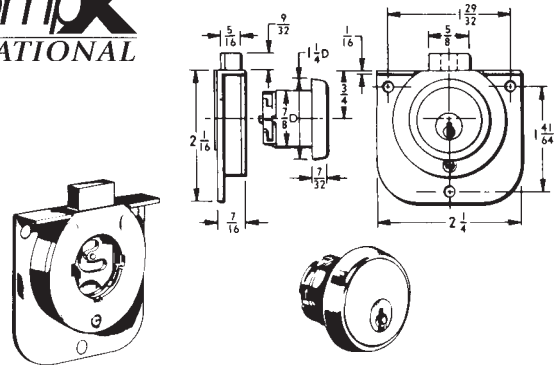

NL-C8161

NL-C8160

Stock #	Mounting or Installation	Bolt Type	Min. Material Thickness	Bolt Travel	Keyed Alike Numbers Available
NL-C8160-26D	In Housing	—	—	—	—
NL-C8161-26	Drawer	Dead	7/8"	9/32"	—

DISC TUMBLER DRAWER LOCKS

APPLICATION—For center drawers of metal desks. Fits special piercing of drawer front and selvage (see drawing). 1/4" max. mat'l. thickness

OPERATION—Key removable in both locked and unlocked positions.

KEYING—Will key together with all other disc tumbler locks using D8785 key blank. Available keyed different (**KD**) or keyed alike (**KA**).

KEY BLANK—D8785.

PACKAGING—Supplied with two keys and mounting nut.

FINISHES—**14A**- Bright Nickel

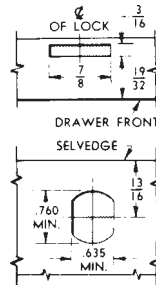

Stock #	Mounting or Installation	Bolt Type	Cylinder Length	Bolt Travel	Keyed Alike Numbers Available
NL-C8701-14A	Drawer*	Reinforced, Insertable Dead Bolt	19/32"	11/32"	C413A, C415A

*Metal drawer, 1/4" max. material thickness.

Available **KD**-Keyed Different or **KA**-Keyed Alike. *Specify KD or KA*

CHEST, CUPBOARD & DRAWER LOCKS

DISC TUMBLER DOOR AND DRAWER LOCKS



APPLICATION—For drawers and doors. Surface mounted. Requires 7/8" dia. hole for cylinder.

OPERATION—Key removable in both locked and unlocked positions, except NL-C8706.

KEYING—Will key together with all other disc tumbler locks using D8785 key blank. Available keyed different (**KD**) or keyed alike (**KA**).

KEY BLANK—D8785.

PACKAGING—Supplied with two keys and mounting screws(NL-C8706 furnished with strike).

FINISHES—**3**-Bright Brass, **4G**-Antique Brass, **14A**- Bright Nickel.

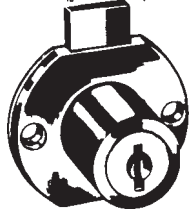
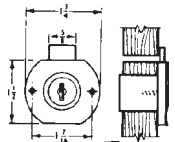

NL-C8703
NL-C8705

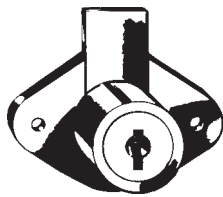
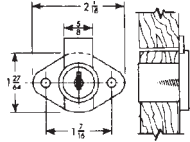

NL-C8803

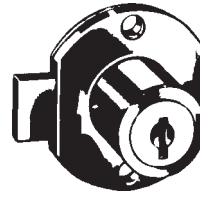
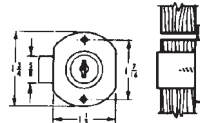

NL-C8704

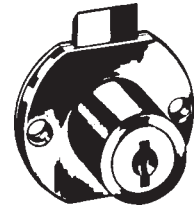
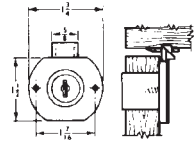

NL-C8706

<u>Stock #</u>	<u>Installation</u>	<u>Bolt Type</u>	<u>Cylinder Length</u>	<u>Bolt Travel</u>	<u>Keyed Alike Numbers Available</u>
NL-C8703-3	Drawer	Dead	15/16"	11/32"	C346A, C413A, C415A, C420A, C642A
NL-C8703-4G	Drawer	Dead	15/16"	11/32"	C346A, C642A
NL-C8703-14A	Drawer	Dead	15/16"	11/32"	C346A, C415A, C420A, C642A
NL-C8704-3	Door	Dead	15/16"	11/32"	C413A, C415A, C642A
NL-C8704-4G	Door	Dead	15/16"	11/32"	C642A
NL-C8704-14A	Door	Dead	15/16"	11/32"	C415A, C642A
NL-C8705-3	Drawer	Dead	1-3/16"	11/32"	C413A, C415A
NL-C8705-4G	Drawer	Dead	1-3/16"	11/32"	C413A, C415A
NL-C8705-14A	Drawer	Dead	1-3/16"	11/32"	C413A, C415A
NL-C8706-3	Drawer	Spring	15/16"	9/32"	C413A, C415A
NL-C8803-3	Drawer	Dead	15/16"	11/32"	C346A, C390A, C413A, C415A, C642A
NL-C8803-4G	Drawer	Dead	15/16"	11/32"	C413A, C415A
NL-C8803-14A	Drawer	Dead	15/16"	11/32"	C346A, C415A, C420A

Available **KD**-Keyed Different or **KA**-Keyed Alike. *Specify KD or KA*

CHEST, CUPBOARD & DRAWER LOCKS



All Timberline Locks consist of two separate components: a lock plug and a cylinder body. A change tool (TB-D500KY) is required to remove lock plugs from the cylinder bodies.

REMOVABLE LOCK PLUG SYSTEM

- Wide selection of locks to fit most furniture & cabinet applications.
- Available in several high quality finishes.
- Removable lock plugs for complete keying versatility.
- Prepackaged in poly-bags for easy distribution to your customer.

These lock plugs will fit in ALL Timberline Locks



<u>Stock No.</u>	<u>Finish</u>
TB-C100LP-14A	Polished Nickel
TB-C200LP-8	Old English
TB-C300LP-19	Black
TB-C400LP-20	Statuary Bronze
TB-C500LP3	Polished Brass

Available Keyed Different (KD) or Keyed Alike (KA): 100T or 105T

DOOR LOCKS



TB-C240CB

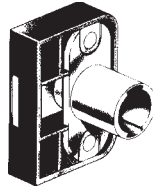

TB-C290CB

APPLICATION—Surface mounted lock for locking doors.
OPERATION—180° key rotation, CCW to lock, key removable in both locked and unlocked positions.
KEYING—Order lock plug separately. (See above)
PACKAGING—Housing is black, toughened nylon. Cylinder is unplated. Cams are zinc plated.

<u>Stock No.</u>	<u>Cam Setback</u>	<u>Cam Extension*</u>	<u>Cam Throw</u>
TB-C240CB	3/32"	15/16"	1/2"
TB-C290CB	9/32"	13/16"	3/8"

*Measured from center of cylinder to tip of cam in unlocked position.

DRAWER LOCKS



TB-C230CB

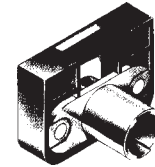

TB-C280CB

APPLICATION—Surface mounted lock for locking drawers.
OPERATION—180° key rotation, CCW to lock, key removable in both locked and unlocked positions.
KEYING—Order lock plug separately. (See above)
PACKAGING—Housing is black, toughened nylon. Cylinder is unplated. Cams are zinc plated.

<u>Stock No.</u>	<u>Cam Setback</u>	<u>Cam Extension*</u>	<u>Cam Throw</u>
TB-C230CB	3/32"	15/16"	1/2"
TB-C280CB	9/32"	13/16"	3/8"

*Measured from center of cylinder to tip of cam in unlocked position.

CAM LOCK KIT—TB-C165CB

APPLICATION—Universal type lock for either doors or drawers. Kit contains a variety of easily switched cams to accommodate most locking situations.
OPERATION—90° key rotation, CCW to lock.
KEYING—Order lock plug separately. (See above)
PACKAGING—Cylinder supplied with two straight cams and two bent cams. Cylinder is unplated. Cams are zinc plated.

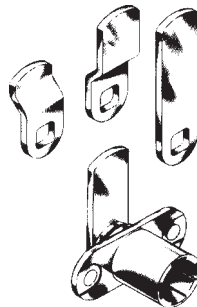

<u>Stock No.</u>	<u>Description</u>
TB-C165CB	Cam Lock Kit

This kit will replace the following Timberline cam locks:

<u>90° Rotation</u>		<u>180° Rotation</u>	
CB-080	CB-090	CB-180	CB-190
CB-083	CB-093	CB-183	CB-193
CB-084	CB-094	CB-184	CB-194
CB-085	CB-095	CB-185	CB-195
CB-087	CB-097	CB-187	CB-197
CB-088	CB-098	CB-188	CB-198

Need a lock not shown here?? Then just give us a call 1-800-848-1577.

Also be sure to check "DESKS LOCK" if you cannot find it here.

CHEST, CUPBOARD & DRAWER LOCKS

TWO DRAWER SIDE GANG LOCK—TB-D270CB

APPLICATION—Two drawer gang lock for locking two pedestal drawers with a single lock. Lock mounts on side of cabinet.

OPERATION—180° key rotation, CCW to lock. Key removable in both locked and unlocked position.

KEYING—Order lock plug separately. (See previous page)

PACKAGING—Housing supplied with two C500DC-19 Drawer Clips. Housing is black, toughened nylon. Cylinder is unplated. Cams are zinc plated.

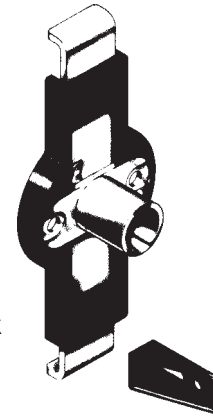

<u>Stock No.</u> TB-D270CB	<u>Description</u> Side Gang Lock
-------------------------------	--------------------------------------

DOUBLE DOOR LOCKS

APPLICATION—Surface mount lock for locking two adjacent doors. Eliminates the need for a spring catch on the door opposite the lock. Works with either overlay or inset doors.

OPERATION—180° key rotation, CCW to lock. Key removable in both locked and unlocked position.

KEYING—Order lock plug separately. (See previous page)

PACKAGING—Supplied with two strike plates as shown. Housing is black, toughened nylon. Cylinder is unplated. Cams are zinc plated.

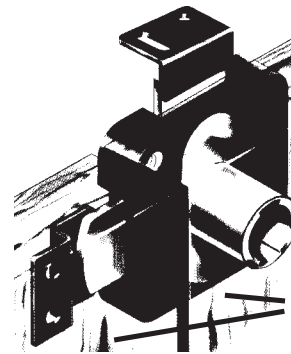

<u>Stock No.</u> TB-C250CB	<u>Description</u> Double Door Lock
-------------------------------	--

Top Cam Setback: 3/16"
 Top Cam Extension*: 29/32"
 Side Cam Setback: 3/32"
 Side Cam Extension*: 29/32"
 Cam Throw: 1/2"

*Measured from center of cylinder to tip of cam in unlocked position.

Locks both doors without the use of a spring catch.

THICK PANEL LOCK

APPLICATION—Universal type lock for either doors or drawers that can accommodate panel thickness from 7/8" to 1-3/8" thick.

OPERATION—90° key rotation, CCW to lock.

KEYING—Order lock plug separately. (See previous page)

PACKAGING—Housing supplied with straight cam and bent cam. Housings are unplated. Cams are zinc plated.

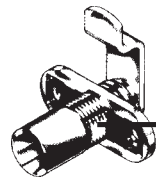

<u>Stock No.</u> TB-C170CB	<u>Description</u> Thick Panel Lock
-------------------------------	--

Mounting flange adjust to allow lock to be mounted in panels from 7/8" thick up to 1-3/8" thick.

PUSH LOCK

APPLICATION—For locking sliding, bypass type doors. Requires 3/4" hole in front door for cylinder.

OPERATION—Pushing in cylinder locks doors, with or without key. 45° key rotation allows cylinder to pop back out to unlock doors. Key removable in both locked and unlocked positions.

KEYING—Order lock plug separately. (See previous page)

PACKAGING—Supplied with nickel plated finished cup as shown. Housing is black, toughened nylon.

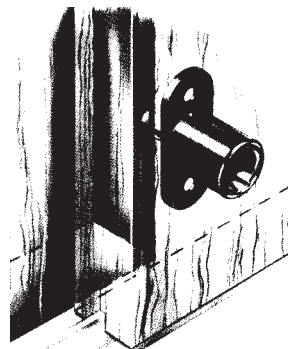

<u>Stock No.</u> TB-C175CB	<u>Description</u> Push Lock
-------------------------------	---------------------------------

CHEST, CUPBOARD & DRAWER LOCKS



GANG LOCK CYLINDER BODY

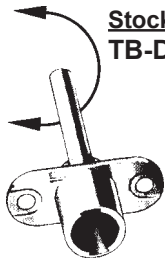

Stock No.
TB-D100CB

Description
For Front Mount Systems

See previous page
for lock plugs.

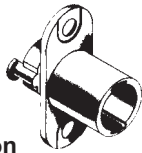

Stock No.
TB-D150CB

Description
For Side Mount Systems

BEZELS

- Allows cylinder bodies to be used with 3/4" through 7/8" diameter holes and permits use of locks in 7/8" thick panels.



Stock No.
TB-C100BZ-14A
TB-C200BZ-8
TB-C300BZ-19
TB-C400BZ-20
TB-C500BZ-3

Finish
Bezel Nickel
Bezel Old English
Bezel Black
Bezel Statuary Bronze
Bezel Brass

STRIKE PLATES



TB-C100SP-19



TB-C101SP-19

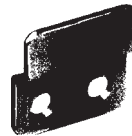

TB-C257SP-19

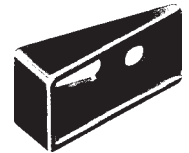

TB-C500DC-19



TB-C185SP-19

TOOLS



TB-C165DB
16.5mm Drill Bit

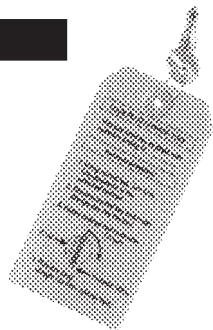

TB-D500KY
CHANGE TOOL
This tool required to remove lock plugs from cylinder bodies.

DESK LOCKS

BOLT TYPE LOCKS



- Five Disc tumbler.
- Removable plug feature.
- Steel locking bolt.
- Furnished with two keys per lock.

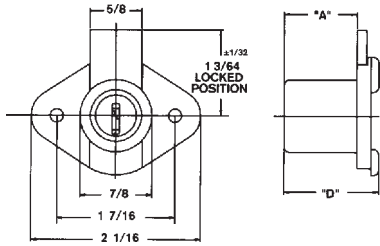

C1968

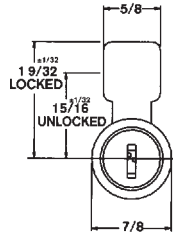

C1975

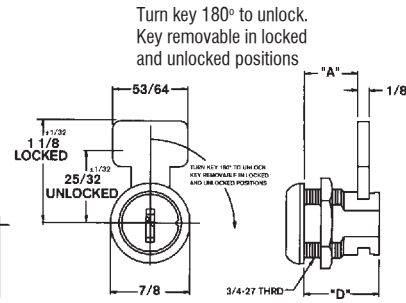

C1974

Stock No.	A	D	Finish	Keyed Alike Numbers Available
C1968	57/64"	1-5/32"	Brushed Brass	1289, 1454
C1974	19/32"	27/32"	Satin Chrome	1289, 1454
C1975	21/32"	57/64"	Satin Chrome	1289, 1454

Available **KV**-Keyed Different or **KA**-Keyed Alike. *Specify KV or KA*

*KV indicates the majority of the quantity of locks will be keyed different. A lesser quantity will potentially be keyed alike to one or more key numbers. We can not guarantee that we can ship keyed DIFFERENT locks.

23000 SERIES MULTI-FUNCTION METAL DRAWER LOCK w/UNIVERSAL KEYWAY



- Single bitted.
- Multi-function—2 bolt throw heights.
- Bolt notched for assembled installation.
- 90° key turn to open.
- Key removable locked or unlocked.
- Removable cylinder for rekeying.
- Finish: Brass or Stainless Steel.
- Two keys furnished per lock.

Stock No	Keying
MFW-23010 KD	Keyed Different
MFW-23010 KA	Keyed Alike—217, 221, 224, 237, 238

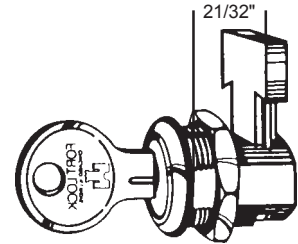

PIN TUMBLER DOOR DRAWER LOCKS

APPLICATION—For center drawers of desks. Fits special piercing of drawer front and selvedge (see drawing). Reinforced insertable dead bolt. Metal drawer, 1/4" Max. material thickness.

OPERATION—Key removable in both locked and unlocked positions.

KEYING—Will key together with all other pin tumbler locks using D4291 key blank except NL-C8700 mail box locks. Available keyed different (**KD**) or keyed alike (**KA**).

KEY BLANK—D4291.

PACKAGING—Supplied with two keys and mounting nut.

FINISHES—26D- Dull Chrome.

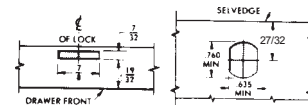

Mounting Holes



Stock #	Mounting or Installation	Bolt Type	Cylinder Length	Bolt Travel	Keyed Alike Number Available
NL-C8137-26D	Drawer	Reinforced, Insertable Dead Bolt	19/32"	7/16"	107, 915

Available **KD**-Keyed Different or **KA**-Keyed Alike. *Specify KD or KA*

©ZIPF LOCK COMPANY

Also be sure to check "CHEST, CUPBOARD & DRAWER LOCKS" if you cannot find it here.

DESK LOCKS

DISC TUMBLER DRAWER LOCKS

APPLICATION—For center drawers of metal desks. Fits special piercing of drawer front and selvage (see drawing). 1/4" max. mat'l. thickness

OPERATION—Key removable in both locked and unlocked positions.

KEYING—Will key together with all other disc tumbler locks using D8785 key blank. Available keyed different (**KD**) or keyed alike (**KA**).

KEY BLANK—D8785.

PACKAGING—Supplied with two keys and mounting nut.

FINISHES—14A- Bright Nickel

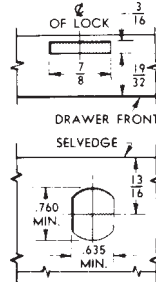

<u>Stock #</u>	<u>Mounting or Installation</u>	<u>Bolt Type</u>	<u>Cylinder Length</u>	<u>Bolt Travel</u>	<u>Keyed Alike Numbers Available</u>
NL-C8701-14A	Drawer*	Reinforced, Insertable Dead Bolt	19/32"	11/32"	C413A, C415A

*Metal drawer, 1/4" max. material thickness.

Available **KD**-Keyed Different or **KA**-Keyed Alike. *Specify KD or KA*

FILE CABINET LOCKS

- Four Pin tumbler plug.
- Satin Chrome finish.
- Die Cast barrel with die cast bolt.
- 5002LP has rectangular bolt.
- Other models have round bolt.
- 2 keys per lock.

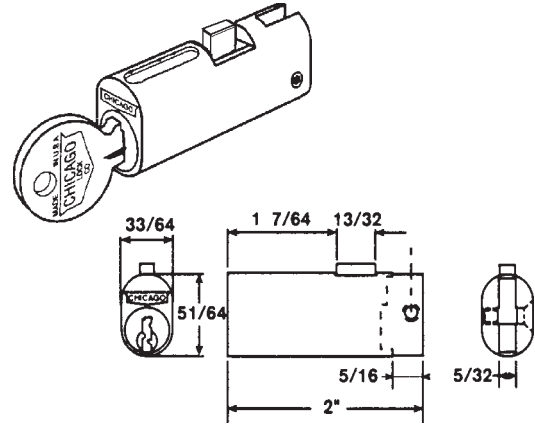
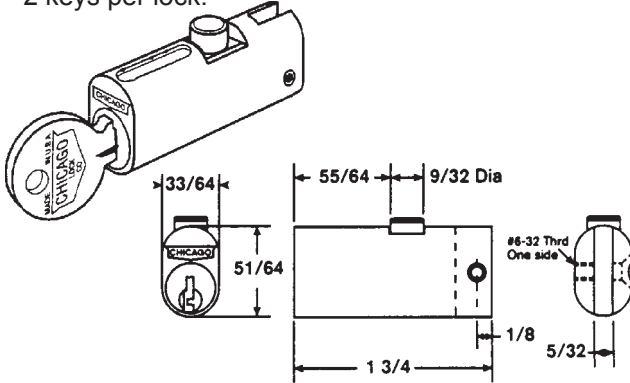

Stock No.	Description
C5001LP KV	Keyed Different*
C5001LP KA	Keyed Alike: SPECIFY KA# 1x03, 1x04, 1x20, 2x01, 2x02, 3x5

Stock No.	Description
C5002LP KV	Keyed Different*
C5002LP KA	Keyed Alike: SPECIFY KA# 1x03, 1x04, 1x20, 2x01, 2x02, 3x5

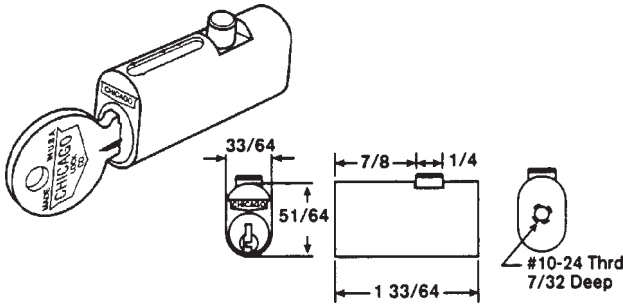

*KV indicates the majority of the quantity of locks will be keyed different. A lesser quantity will potentially be keyed alike to one or more key numbers. We can not guarantee that we can ship keyed DIFFERENT locks.

Stock No.	Description
CEXP-19DC KV	Keyed Different*
CEXP-19DC KA	Keyed Alike: 5x75

PIN TUMBLER FILE CABINET LOCK



APPLICATION—Used internally on filing cabinets to gang lock drawers.

OPERATION—Key removable in locked position only.

KEYING—Will key together with all other pin tumbler locks using D4291 key blank except NL-C8700 series mail box locks. Available keyed different (KD) or keyed alike (KA# 107).

KEY BLANK—D4291.

PACKAGING—Supplied with two keys.

FINISHES—26D-Dull Chrome.

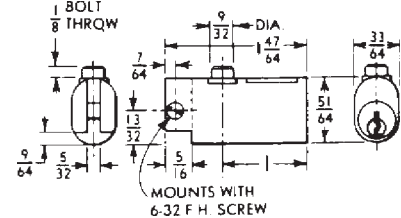
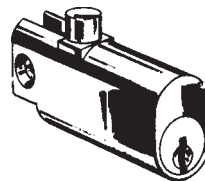

NL-C8150-26D

Stock #	Installation	Bolt Type	Cylinder Length	Bolt Travel	Keyed Alike Numbers Available
NL-C8150-26D	File Cabinet	Spring	—	1/8"	107, 915

Available KD-Keyed Different or KA-Keyed Alike. Specify KD or KA

FILE CABINET LOCKS

DISC TUMBLER FILE CABINET LOCK

APPLICATION—Used internally on filing cabinets to gang lock drawers.

OPERATION—Key removable in locked position only.

KEYING—Keyed only to "Pundra" keyway.

KEY BLANK—D8776.

PACKAGING—Supplied with two keys.

FINISHES—26-Bright Chrome.

**CompX
NATIONAL**

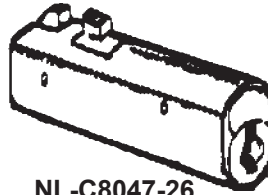

NL-C8047-26

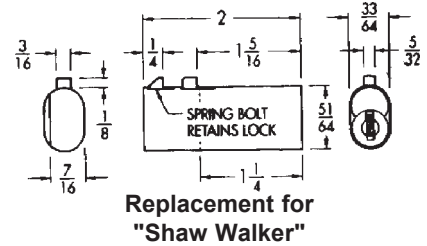

Stock #	Installation	Bolt Type	Cylinder Length	Bolt Travel	Keyed Alike Numbers Available
NL-C8047-26	File Cabinet	Spring	—	1/8"	P141A

Available **KD**-Keyed Different or **KA**-Keyed Alike. *Specify KD or KA*

ES-1750 Series Pin Tumbler File Cabinet Locks



- 4 pin tumbler cylinder.
- Regularly furnished with 2 keys, ES1 key blanks.
- Available keyed alike (KA) or keyed different (KD).

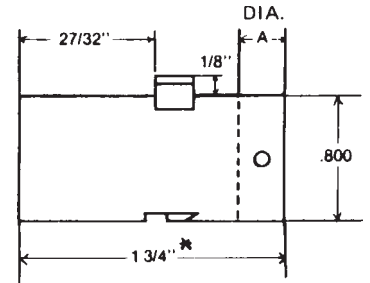
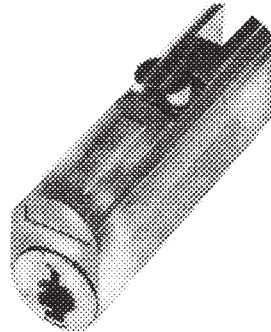
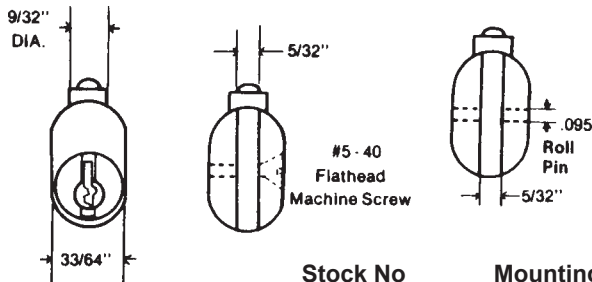

Stock No	Mounting	"A" Dimension	Keyed Alike Number Available
ES-1750P312	roll pin	5/16"	L009
ES-1750S312	machine screw	5/16"	L009
ES-1750P500	roll pin	1/2"	L006
ES-1750S500	machine screw	1/2"	L008

TO ORDER: Specify Stock No. and keying (KA or KD)

NOTE: 312 Series replacement for Hon. Equivalent to Chicago 5001LP.
500 Series replacement for Anderson Hickey. Equivalent to Chicago 5001-50LP.

CHROME FILE CABINET LOCK

- Single bitted.
- Keyway: HL1
- 1-3/4" length.

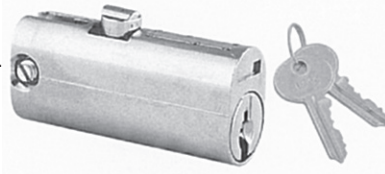

TET

CONVERSION CHART
For **FD1341**:
Chicago: C5001-LP
ESP: 1750S312
National: C8150
For **FR1341**:
ESP: 1750S500

Stock No.	Slot Depth	Keyed Alike Number Available
JT-FD1341	1/2"	L009
JT-FR1341	5/16"	L009

Available **KD**-Keyed Different or **KA**-Keyed Alike.
Specify KD or KA

PRO-LOK®

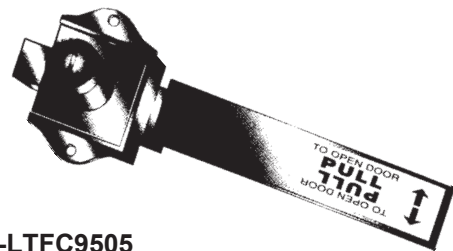

PK-LTFC9505
Fire Cabinet Lock

Self contained trip lever cylinder lock assembly fits glass fire cabinet doors. Keyed alike LL24.

©ZIPF LOCK COMPANY

HANDLE LOCKS

DISC TUMBLER HANDLE LOCKS

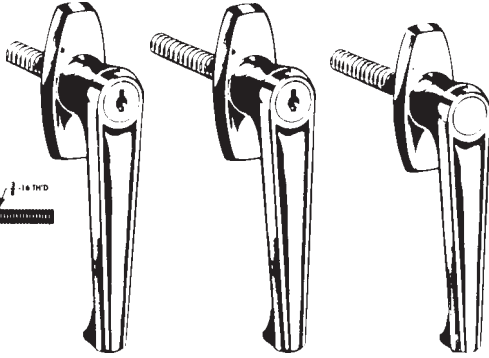
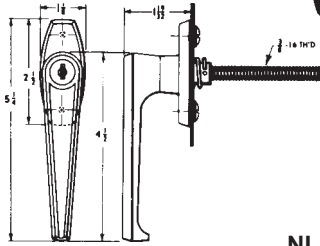

NL-C8751

NL-C8754

NL-C8755

APPLICATION—For doors on metal lockers and cabinets. For R.H. doors, install with escutcheon vertical. For L.H. doors, install with escutcheon horizontal. Choice of spindle lengths and mounting. Spindles accept both NL-C8756 latch plate and NL-C8757 tongue. NL-C8749 will accept only the NL-C8757 tongue. Spindles can be cut to fit special requirements.

OPERATION—Key removable in both locked and unlocked positions.

KEYING—Will key together with all other disc tumbler locks using D8785 key blank.

KEY BLANK—D8785.

PACKAGING—Supplied with two keys (except NL-C8755) and mounting hardware.

FINISHES—26D-Dull Chrome.

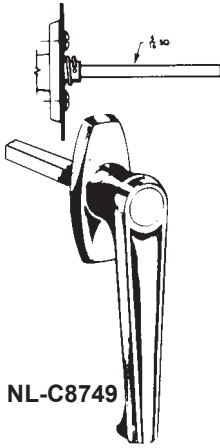

NL-C8749

CompX
NATIONAL

Stock #	Type of Mounting	Spindle Length	Direction of Turn to Open	Keyed Alike Numbers Avail.
NL-C8749-26D	Rear	4"***	90° c/cw	C415A
NL-C8751-26D	Rear	1"	90° c/cw	C413A, C415A
NL-C8754-26D	Rear	3"	90° c/cw	C413A, C415A
NL-C8755-26D*	Rear	3"	90° c/cw	—
NL-C8758-26D	Thru-the	1"	90° c/cw	C413A
NL-C8759-26D	Escutcheon	3"	90° c/cw	C413A, C415A

*Non-locking handle. **5/16" sq. spindle

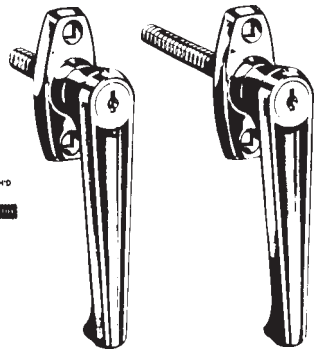
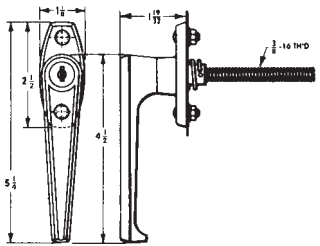

NL-C8758

NL-C8759

LATCH PLATE & TONGUE FOR ABOVE HANDLE LOCKS

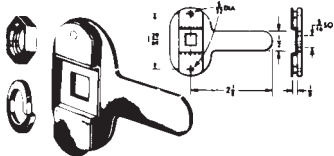

NL-C8756-2C

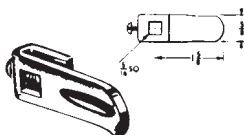

NL-C8757-2C

Stock No.	Description	Method of Attachment to spindle
NL-C8756-2C	3 point latch plate with tongue. Used with locking bars.	Hex nuts with lock washers threaded on spindle.
NL-C8757-2C	Single point latch tongue	Side mounted set screw

PIN TUMBLER KNOB LOCKS

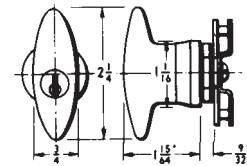
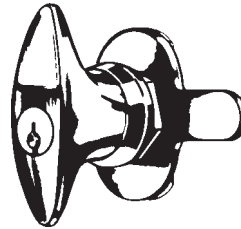

NL-C8154, NL-C8155

APPLICATION—For metal cabinet doors. Reversible for R.H. or L.H. application. Latch plate is used for either in 2* or 3 point latching. (*Install with tongue pointing away from jamb.)

OPERATION—90° turn to open. Choice of key operation, see below.

KEYING—Will key together with all other pin tumbler locks using D4291 key blank except NL-C8700 series mail box locks. Available keyed different or keyed alike.

KEY BLANK—D4291.

PACKAGING—Supplied with two keys, mounting nut and screw for latch plate.

FINISHES—26D-Dull Chrome.

Stock #	Description	Max. Mat. Thick.	K.A. No.
NL-C8154-26D	Key removable in both locked /unlocked positions	1/8"	107
NL-C8155-26D	Key removable in locked position only	1/8"	107, 915

©ZIPF LOCK COMPANY

KEYING KITS

ORIGINAL KITS

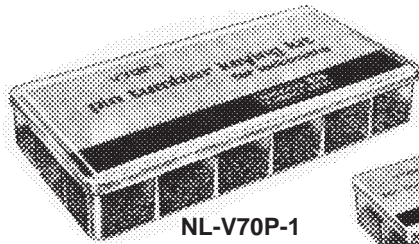

NL-V70P-1

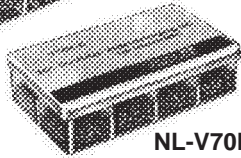

NL-V70P-2

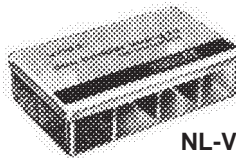

NL-V71D-3

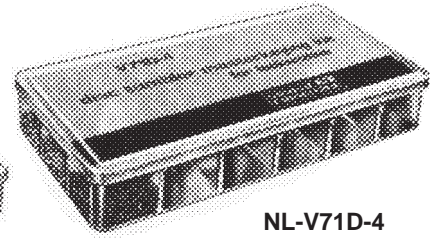

NL-V71D-4

NL-V70P-1 Pin Tumbler Keying Kit, includes:
 100 Pcs. ea. 1, 2, 3 and 4 Drivers.
 100 Pcs. ea. 0, 1, 2, 3, 4, 5, 6, 7, 8 and 9 Tumblers.
 250 Pcs. ea. Tumbler Springs.
 100 Pcs. ea. Tumbler Retainers.
 50 Pcs. ea. C3735 and C3738 Plug Retainers.

NL-V70P-2 Pin Tumbler Masterkeying Kit, includes:
 100 Pcs. ea. 2, 3, 4, 5, 6, 7, 8 and 9 Master Drivers.

NL-V71D-3 Disc Tumbler Keying Kit, includes:
 100 Pcs. ea. 00, 22, 44, and 66 Tumblers.
 250 Pcs. Tumbler Springs.

NL-V71D-4 Disc Tumbler Masterkeying Kit, includes:
 100 Pcs. ea. 02, 04, 06, 20, 24, 26, 40, 42, 46, 60, 62 and 64 Tumblers.
 250 Pcs. Tumbler Springs.

SCHLAGE



Stock No. **Description**
SC-40-134 **Keying Kit. Snap-Tight Plastic Box**
 Contents: Bottom pins, top pins, pin springs, retainer cap pins & springs, key gauge, Follower bar, T-pin spring, T-pin, removeable cap.

Stock No. **Description**
SC-40-119 **Key Kit Seal-Tight Metal Box**
 Contents: Bottom pins, master pins, top pins, pin springs, retainer caps, retainer cap pins, retainer cap pin springs, shim stock, tweezers, follower bar, removal tool, T-pin spring, T-pin, removeable cap.



Stock No. **Description**
SC-40-095 **Compressable cylinder update kit**
 Contents: Top t-pin, Top T-pin spring, removeable cap, new plastic tray insert, new charts for 40-119, 40-132, 40-133.

Stock No. **Description**
SP-40-070 **Primus® Pin Kit**
 Contents: Side bars, finger pin springs, finger pins, plug holder, sidebar springs.

WEISER LOCK

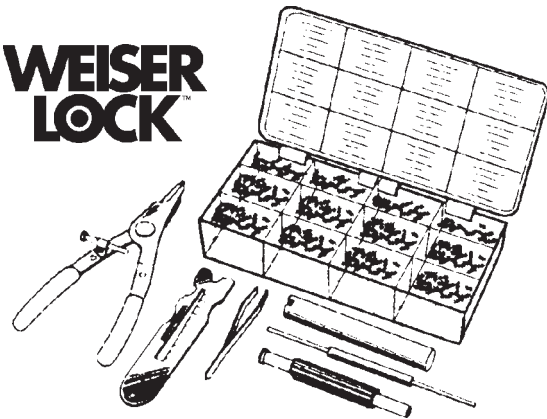

Stock No. **Description**
WE-1418 **Keying kit with tools (pictured)**
 Contents: Keying Tools, Top pins, Bottom pins, Pin tumbler springs, instructions.

Stock No. **Description**
WE-1419 **Cylinder master wafer kit (for master keying).**
 Contents: Top pins, Master wafers.

©ZIPF LOCK COMPANY

For manufacturers not shown, see LAB kits on pages 395-398

LOCKER LOCKS



Built-in Key Operated Locker Locks

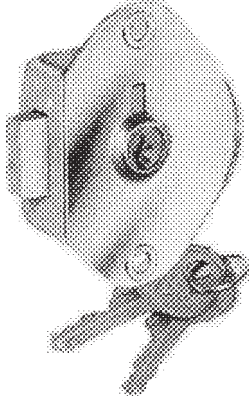

Stock No.	Description
1710	Manual deadbolt locking.
1714	Spring Bolt-Automatic locking

Fits both right and left handed doors.
5 pin tumbler
Stock KD & KA (40H102)
MK Factory Order

Combination Padlocks with Key-Controlled Mechanism. Great for School, Industrial, gymnasium locker rooms.

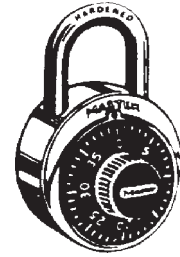

All features of No. 1500, plus key-controlled mechanism with brass cylinder, nickel-silver tumbler security. Designed for special installations such as schools, industrial plants, gymnasium locker rooms, etc. Not recommended for over-the-counter sales. Special security feature — keyway in back of lock. Individual user operates lock by dialing combination. Authorized person has control key, providing easy access to all lockers (control keys must be ordered separately). Installation record maintained at factory, on factory ordered padlocks, permitting extension system under same key.

Stock No.	Description	Minimum of 10 padlocks
1525 V689	Key-controlled Padlock	
1525K V689	V689 Key	

Other numbers factory order only

See "Padlocks" section of catalog for other padlocks.



SmoothSpin™ Combination Padlocks with Key-Controlled Mechanism. Great for School, Industrial, gymnasium locker rooms.

Minimum of 10 padlocks

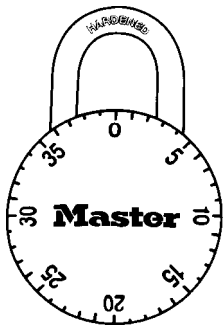

SmoothSpin™ combination Different, control key feature, standard 11/16" shackle clearance, 9/32" shackle diameter, black dial. See 1525 padlock above for more information.

Stock No.	Description
2076 V689	Key-controlled Padlock
1525K V689	V689 Key

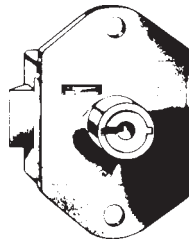

NL-C8402

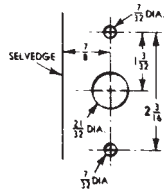

MOUNTING HOLES



Lever Tumbler Locker Locks

APPLICATION—For metal locker doors. Reversible for R.H. or L.H. applications.

OPERATION—NL-C8402: Key removable only in locked position.

KEYING—Each lock keyed different, masterkeying to 5L.

KEY BLANK—D8192.

FINISH—2C-Zinc Plated.

PACKAGING—Supplied with two keys; no mounting hardware is furnished.

Stock No.:	NL-C8402-2C
Type of Mounting:	Box Lockers
Bolt Type:	Spring
Cyl. Lgth.:	5/16"
Bolt Travel:	9/32"

MAIL BOX LOCKS

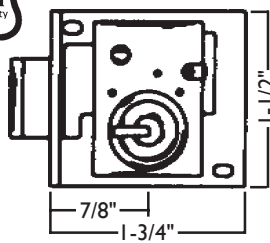
Stock No. B25389
Description 3 lever Steel

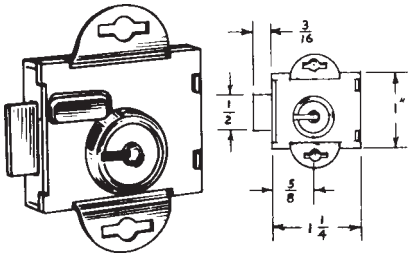

Stock No. LOR-1600
LOR-1625
Description 3/16" Bolt Throw
1/2" Bolt Throw



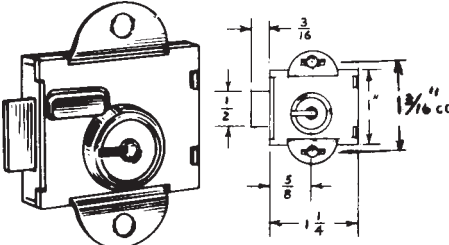

Stock No. LOR-1675
Description 3/16" Bolt Throw For Couch

Stock No. LOR-1650
Description 3/16" Bolt Throw

CHROME MAILBOX LOCKS

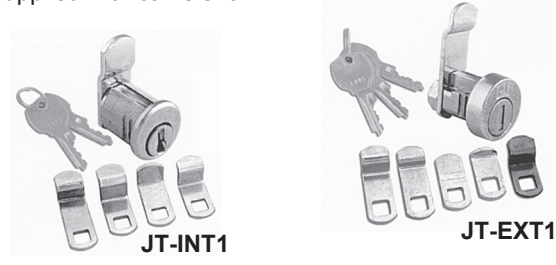
- Single bitted.
- Keyway: NA14.
- Supplied with cams shown.



Stock No. JT-MBINT1
Description For interior, Nut or clip mounted

Stock No. JT-MBEXT1
Description For exterior, Clip mounted. Has keyway dust shutter. Available KD-Keyed Different only.



CONVERSION CHART

Jet	National
MBINT1	C8730
MBEXT1	C8735

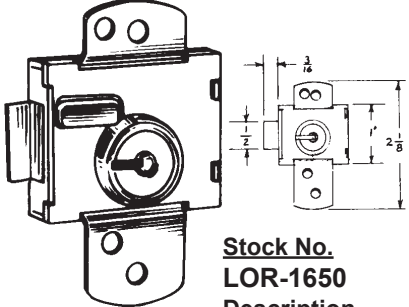

Stock No. LOR-1650
Description 3/16" Bolt Throw

Pin Tumbler "Multi-Cam"™ Mail Box Locks

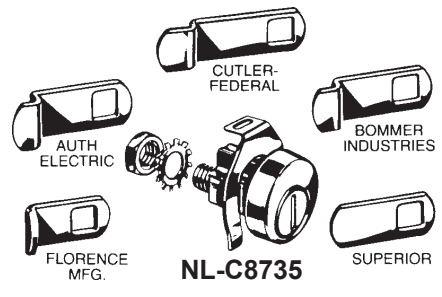
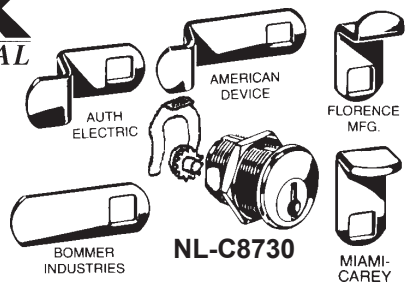

This lock meets U.S.P.S. specification #L-1172 and drawing #1003833 for NDCBU and CBU applications.

APPLICATION—Interior architectural mail boxes used in apartments, condominiums, schools, lobbies. **Nut or clip mounted.**

OPERATION—90° counter-clockwise cam turn to open. Key removable in locked position only.

KEYING—Available keyed different only.

KEY BLANK—D4291.

PACKAGING—Supplied with selection of five cams, two keys, mounting nut, mounting clip and cam screw.

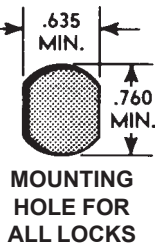

APPLICATION—Exterior pedestal-mounted neighborhood boxes. Has keyway dust shutter for lock protection. **Clip mounted.**

OPERATION—90° clockwise cam turn to open. Key removable in locked position only.

KEYING—Available keyed different only.

KEY BLANK—D4291.

PACKAGING—Supplied with selection of five cams, three keys, mounting clip, cam locking nut.

Stock No.	Installation	Direction of Turn to Open	Key Blank
NL-C8730-14A	Architectural Mail Box Fronts	90°c/cw	D4291
NL-C8735-14A	Door of Pedestal Mounted Neighborhood Boxes	90°cw	D4291

©ZIPF LOCK COMPANY

MAIL BOX LOCKS



Pin Tumbler Mail Box Locks GENUINE FACTORY REPLACEMENT LOCKS

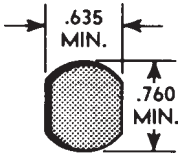

MOUNTING HOLE FOR ALL LOCKS

APPLICATION—For doors on architectural mail boxes serviced by United States Postal Service.

OPERATION—90° cam turn. See drawings for specific operation. Key removable in locked position only.

KEYING—Available keyed different only.

KEY BLANK—D4291

FINISHES—14A-Bright Nickel

PACKAGING—Supplied with two keys and spring mounting clip. NL-C8720 furnished with trim ring.



SPRING MOUNTING CLIP

*NL-C8712 & 8720 are provided with a threaded cylinder, with proper clip grooving.

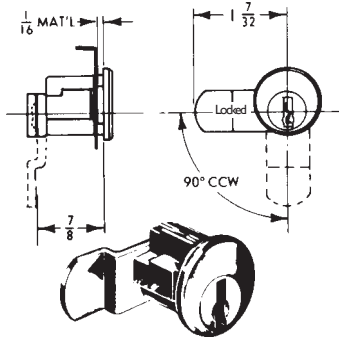

NL-C8710

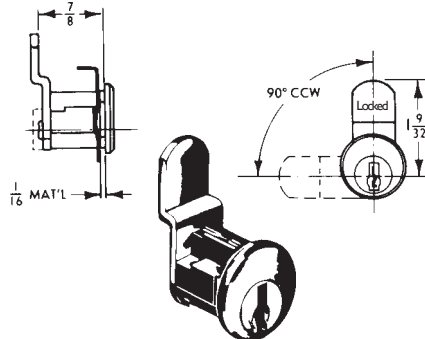

NL-C8711

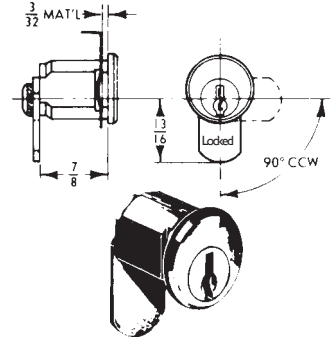

NL-C8712*

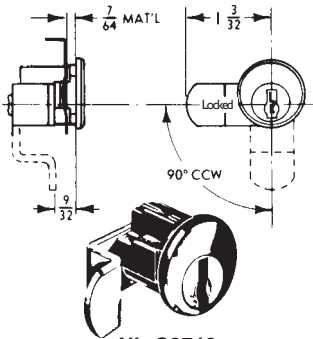

NL-C8713

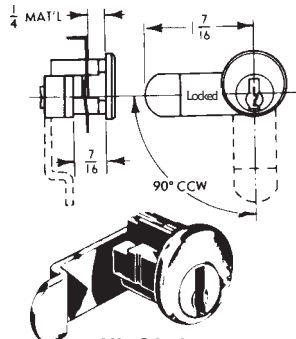

NL-C8714

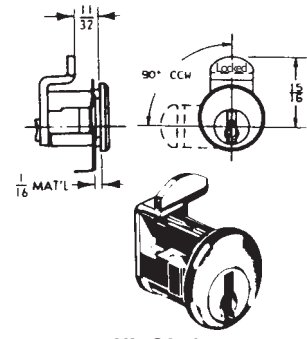

NL-C8715

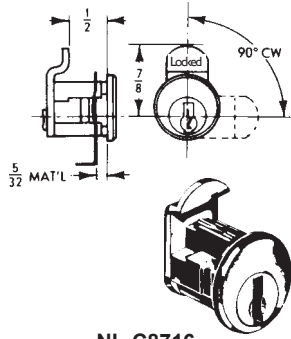

NL-C8716

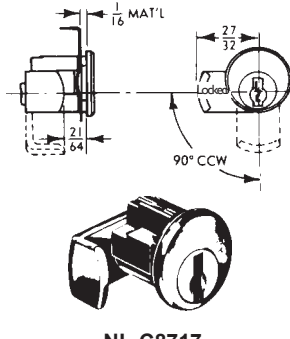

NL-C8717

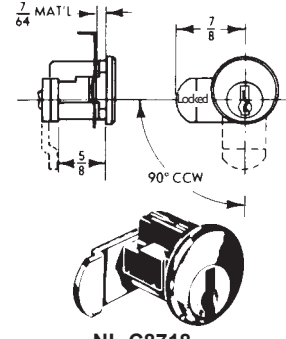

NL-C8718

See next page for additional information.

MAIL BOX LOCKS



Pin Tumbler Mail Box Locks (cont.)

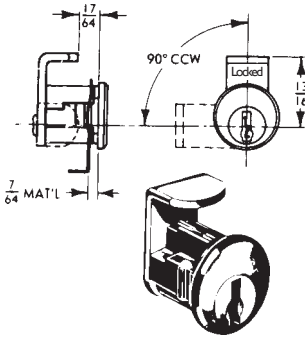

NL-C8719

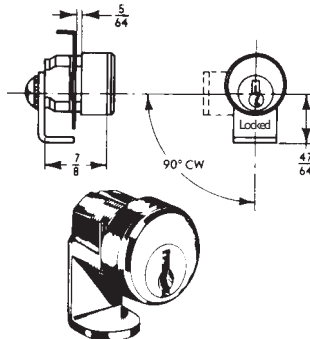

NL-C8720*

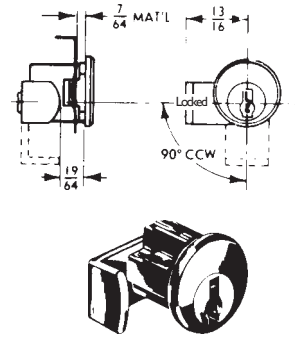

NL-C8721

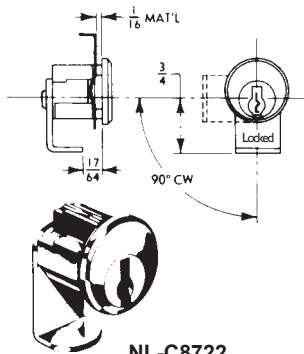

NL-C8722

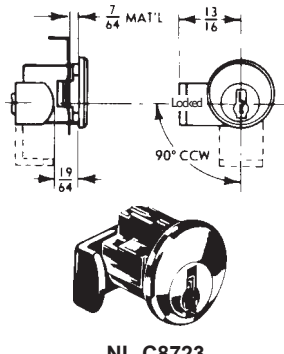

NL-C8723

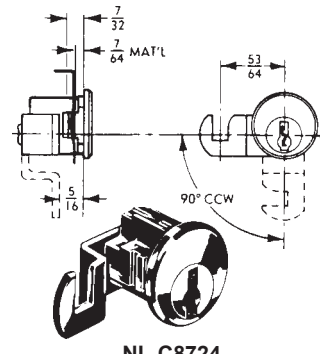

NL-C8724

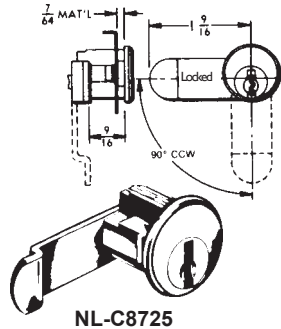

NL-C8725

NEW POSTAL LOCKS

Only approved mailbox lock to fit new USPS-STD-4C boxes

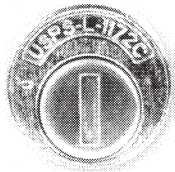
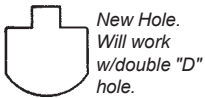

NL-C9100
NL-C9200*

*Shipped w/o a cam for replacement of locks for new standard 4C boxes

- Stainless steel plug.
- 12 degree taper on cylinder head.
- Now able to accommodate up to 3/16" cam.
- Drain holes on the bottom of the cylinder.
- Will include spring clip, mounting nut and 3 keys.
- How lock opens determines key rotation.

©ZIPF LOCK COMPANY

Stock No.	Locked Cam Position	Direction of turn to open	Replaces	Key Blank
NL-C8710-14A	Left	90° c/cw	Bommer Industries	D4291
NL-C8711-14A	Up	90° c/cw	Bommer Industries	D4291
NL-C8712-14A	Down	90° c/cw	Bommer Industries	D4291
NL-C8713-14A	Left	90° c/cw	Auth Electric*	D4291
NL-C8714-14A	Left	90° c/cw	American Device	D4291
NL-C8715-14A	Up	90° c/cw	Florence Mfg.	D4291
NL-C8716-14A	Up	90° cw	S.H. Couch	D4291
NL-C8717-14A	Left	90° c/cw	Nutone	D4291
NL-C8718-14A	Left	90° c/cw	Cutler Mail Chute	D4291
NL-C8719-14A	Up	90° c/cw	Miami-Carey	D4291
NL-C8720-14A	Down	90° cw	Dura Steel	D4291
NL-C8721-14A	Left	90° c/cw	Permabilt—XL-201	D4291
NL-C8722-14A	Down	90° cw	Dura Steel—XL-202	D4291
NL-C8723-14A	Left	90° c/cw	Jensen General	D4291
NL-C8724-14A	Left	90° c/cw	Bommer Industries	D4291
NL-C8725-14A	Left	90° c/cw	Cutler Federal	D4291
NL-9100		clockwise	USPS-STD-4C	D4300
NL-9200		c/clockwise	USPS-STD-4C	D4300

* Also replaces Bommer Lock B25-300 used on Bommer Box No. 9015 (sleeve inside box must be removed).

PUSH/PULL/KICK PLATES

COMMERCIAL KICK PLATES

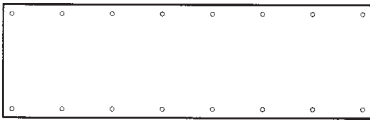

- Paper Wrapped
- Relieved Edges

DISPLAY PACKAGE KICK PLATES

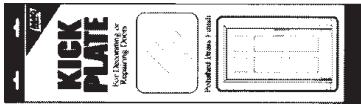

- Carded
- Relieved Edges



Stock No.	Finish	Size
MAG-9002-605 6X28	605	6" x 28"
MAG-9002V-605 6X28	605	6" x 28"
MAG-9003-* 6X30	605,609,613,619,620,628	6" x 30"
MAG-9003V-* 6X30	605,628	6" x 30"
MAG-9004V-630 6X32	630	6" x 32"
MAG-9005-* 6X34	605,609,613,619,620,628,630	6" x 34"
MAG-9005V-605 6X34	605	6" x 34"
MAG-9007-605 8X28	605	8" x 28"
MAG-9007V-605 8X28	605	8" x 28"
MAG-9008-* 8X30	605,613,619,620,628	8" x 30"
MAG-9008V-* 8X30	605,630	8" x 30"
MAG-9009V-* 8X32	605,628,630	8" x 32"
MAG-9010-* 8X34	605,609,613,619,620,628	8" x 34"
MAG-9010V-* 8X34	605,628,630	8" x 34"
MAG-9015-* 10X34	605,613,628	10" x 34"

*=Specify Finish-See page 502 for descriptions., V=Visual Packed

ACE II® 7 PIN TUMBLER SCREW TYPE LOCK

SCREW LOCKS (PL-46)



- Patented ACE II® lock assembly in 3/4" diameter.
- Barrel with two flats — 5/8" across.
- 360° key rotation with keypull every 180° (12 and 6 o'clock).
- Two keys furnished per lock.
- Includes body nut.

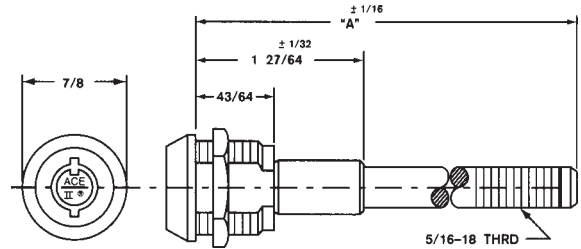

Stock No.	"A"	Keying
CSA4107 KV	7-1/32"	Keyed Different* (KV)
CSA4107 KA	7-1/32"	Keyed Alike (KA) to 7341

*KV indicates the majority of the quantity of locks will be keyed different. A lesser quantity will potentially be keyed alike to one or more key numbers. We can not guarantee that we can ship keyed DIFFERENT locks.

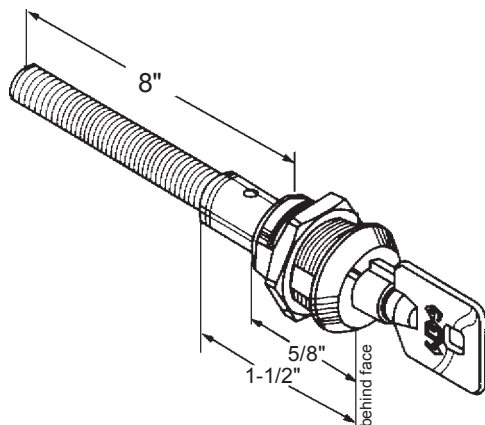

Stock No.	Keying	Key Pulls
TS-1058BD KD	Keyed Different	12 & 6
TS-1058BD KA	Keyed Alike*	12 & 6
TS-1058U KD	Keyed Different	12, 3, 6, & 9
TS-1058U KA	Keyed Alike*	12, 3, 6, & 9

*Specify Keyed Alike#: 27379, 27380, 27381.

18 Threads per inch.

SHOWCASE LOCKS

UNIVERSAL SHOWCASE LOCK

- Single bitted.
- Keyway: HL1.
- Chrome finish.
- Two keys per lock.

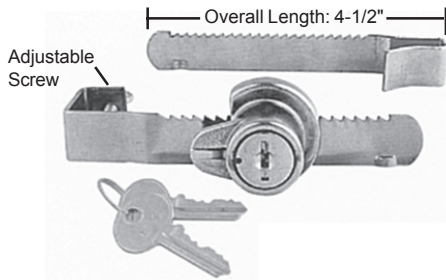

Keyed Alike
Number Available

Stock No.
JT-SC0001 201,217,330

Available **KD**-Keyed Different or **KA**-Keyed Alike.

Specify KD or KA

CONVERSION CHART

Fort: MFWSG23000
ESP: 7/8

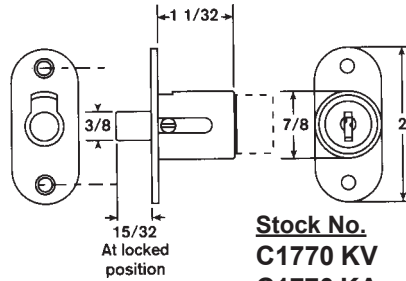

Stock No.
C1770 KV Keyed Different*
C1770 KA Keyed Alike #1289

SINGLE BITTED SLIDING DOOR LOCKS

- Five disc tumbler plug in 7/8" diameter.
- Die cast barrel.
- Keypull in locked and unlocked positions.
- Mounting plate is 5/64" x 7/8" x 2" with 1-1/2" between mounting hole centers.
- Utilizes a spring bolt which locks by pushing the cylinder in and released by turning the key 90° from locked (12:00) to unlocked (3:00) position.
- Two keys per lock.
- Standard Finish - Satin Chrome.

*KV indicates the majority of the quantity of locks will be keyed different. A lesser quantity will potentially be keyed alike to one or more key numbers. We can not guarantee that we can ship keyed DIFFERENT locks.



- Plunger Action, Wood Door Lock.
- 23000 Series Keyway. Disc tumbler.
- Nickel finish.
- 15/32" Bolt Throw.
- **"A" Dimension: 1-1/4"**.
- Key pull at 12:00 only in unlocked position (3:00). Turn key back to 12:00 to remove key, then push plug in to lock.

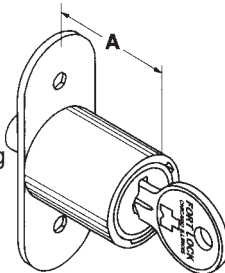

Stock No.
SD-990 KD Keyed Different
SD-990 KA Keyed Alike*
***Specify KA#:** 217, 221, 224, 237, 238.

- 2 one-way bars, wood & glass.
- 90° key turn to open.
- Key removable at 12:00.
- Removable cylinder for rekeying.
- Anti-spread housing.
- Nickel finish.
- Single bitted with universal keyway.

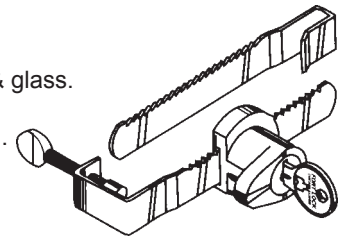

Stock No.
MFWSG-23000 KD Keyed Different
MFWSG-23000 KA Keyed Alike*
***Specify KA#:** 217, 221, 224, 237, 238.

- Plunger Action Wood Door Lock.
- Chrome finish.
- 15/32" bolt throw.
- 90° key turn, plunger slides out to lock.
- **"A" Dimension: 1-1/32"**.
- Key pull at 12:00 only in unlocked position (3:00). Turn key back to 12:00 to remove key, then push plug in to lock.

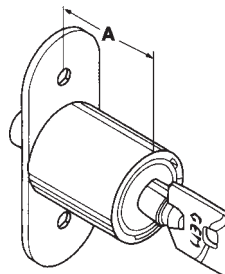

Stock No.
SD-1990 KD Keyed Different
SD-1990 KA Keyed Alike*
***Specify KA#:** 27379, 27380.

- 2 one-way bars, wood & glass.
- Removable cylinder for rekeying.
- Anti-spread housing.
- Nickel finish.
- Double bitted 5 tumbler lock.

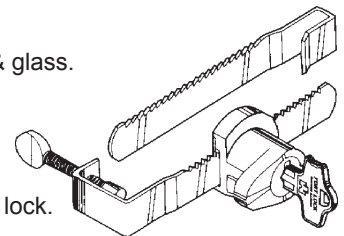

Stock No.
MFWSG-29000 KD Keyed Different
MFWSG-29000 KA Keyed Alike*
***Specify KA#:** D3012, D3045, D3059, D3085, D3165.

©ZIPF LOCK COMPANY

SHOWCASE LOCKS



Disc Tumbler Sliding Door Lock

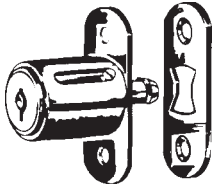

NL-C8042

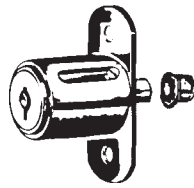

NL-C8043

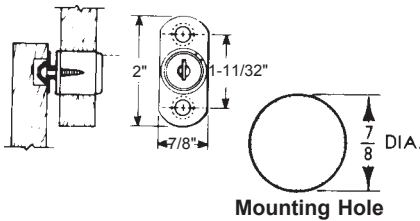

APPLICATION—For wood sliding doors. Requires a 7/8" dia. hole in front door for cylinder.

OPERATION—**C8042** Push in cylinder, key turn engages bolt behind strike. Key removable in both locked and unlocked positions. **C8043** Pushing in cylinder locks doors. Key removable in both locked and unlocked positions.

KEYING—Will key together with all other disc tumbler locks using D8785 key blank. Available keyed alike or keyed different.

KEY BLANK—D8785.

PACKAGING—Each lock supplied with two keys, strike and mounting screws.

FINISH—26D-Dull Chrome

Part No.	Installation	Bolt Type	Cylinder Length	Bolt Travel	Keyed Alike Numbers Available
NL-C8042-26D	Sliding Doors	90° Turn Hook	7/8"	7/16"	C415A
NL-C8043-26D	Sliding Doors	Plunger	1"	7/16"	C346A, C413A, C451A

Available KD-Keyed Different or KA-Keyed Alike. *Specify KD or KA.*



Pin Tumbler Sliding Door Locks

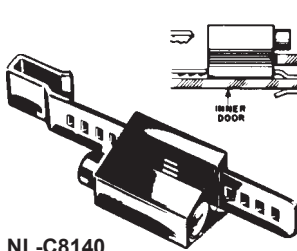

NL-C8140

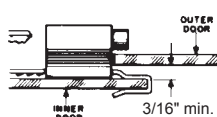

APPLICATION—NL-C8140 is for sliding glass doors. NL-C8142 and NL-C8143 are for wood sliding doors and require a 7/8" hole in the front door for cylinder.

OPERATION—Key removable in locked position only for NL-C8140. Key removable in both locked and unlocked positions for NL-C8142 and NL-C8143.

KEYING—Will key together with all other pin tumbler locks using D4291 key blank except NL-C8700 mail box locks.

FINISH— 4 Satin Brass
26D Dull Chrome

PACKAGING—Supplied with two keys. NL-C8142 and NL-C8143 are furnished with strike and mounting screws.



Mounting Hole

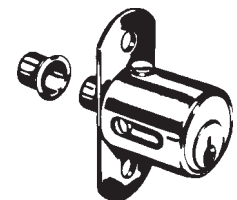
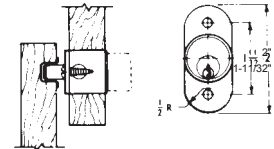

NL-C8142
NL-C8143

Part No.	Installation	Bolt Type	Cylinder Length	Bolt Travel	Keyed Alike Numbers Avail.
NL-C8140-26D	Plate Glass Sliding Doors	Internal Spring	—	—	103, 107
NL-C8142-4	Sliding Doors	Plunger	1-1/8"	7/16"	107
NL-C8142-26D	Sliding Doors	Plunger	1-1/8"	7/16"	101, 103, 107, 915
NL-C8143-4	Sliding Doors	Plunger	1-3/8"	7/16"	107
NL-C8143-26D	Sliding Doors	Plunger	1-3/8"	7/16"	107

Available KD-Keyed Different or KA-Keyed Alike. *Specify KD or KA.*

SWITCH LOCKS



SINGLE POLE, SINGLE THROW DOUBLE BITTED SWITCH LOCKS

- Maintaining contact switch operated by manually rotating inserted key 90° clockwise from open to closed position.
- Momentary contact switch locks features spring return from closed to open position after 90° clockwise key rotation to closed position.
- Contact configuration: SPST.
- 7 amps (resistive) @ 125 Volts A.C. 7 amps @ 28 Volts D.C.
- Electrical Life: 6,000 cycles @ Max. Load.
- Contact Resistance: 50 milli ohms initial maximum.
- Bright Chrome Finish.
- Switches are U.L. Recognized.

Keypull—OFF only; Contact—Maintaining.

<u>Stock No.</u>	<u>Keying</u>
C2174-1DC KV	Keyed Different*
C2174-1DC KA	Keyed Alike—SPECIFY KA# 2001, 2007.

Keypull—OFF & ON; Contact—Maintaining.

<u>Stock No.</u>	<u>Keying</u>
C2174-2DC KV	Keyed Different*
C2174-2DC KA	Keyed Alike—SPECIFY KA# 2001, 2007.

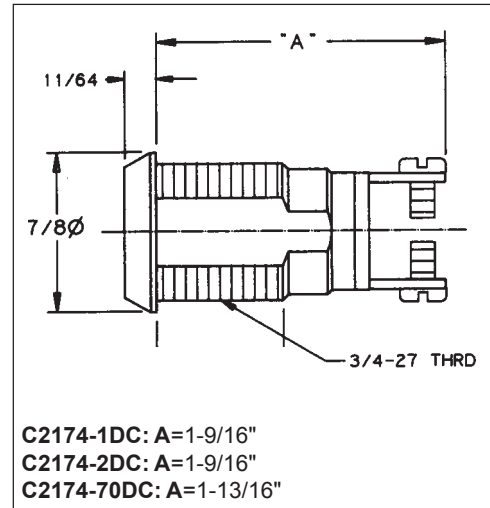

Keypull—OFF only; Contact—Momentary.

<u>Stock No.</u>	<u>Keying</u>
C2174-70DC KV	Keyed Different*
C2174-70DC KA	Keyed Alike—SPECIFY KA# 2001; 2007; 2126; 2382



SINGLE POLE, SINGLE THROW PATENTED ACE II® SWITCH LOCKS

- Maintaining contact switch operated by manually rotating inserted key 90° clockwise from open to closed position.
- Momentary contact switch locks features spring return from closed to open position after 90° clockwise key rotation to closed position.
- Contact configuration: SPST.
- 7 amps (resistive) @ 125 Volts A.C. 7 amps @ 28 Volts D.C.
- Electrical Life: 6,000 cycles @ Max. Load.
- Contact Resistance: 50 milli ohms initial maximum.
- Bright Chrome Finish.
- Switches are U.L. Recognized.

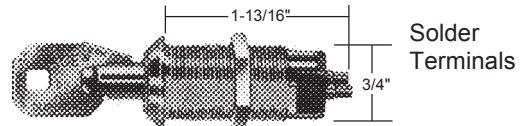

Keypull—OFF Only; Contact—Maintaining.

<u>Stock No.</u>	<u>Keying</u>
C4073-1 KV	Keyed Different*
C4073-1 KA	Keyed Alike—PL927

Keypull—OFF & ON; Contact—Maintaining.

<u>Stock No.</u>	<u>Keying</u>
C4073-2 KV	Keyed Different*
C4073-2 KA	Keyed Alike—PL910, \$PL925

Keypull—OFF Only; Contact—Momentary.

<u>Stock No.</u>	<u>Keying</u>
C4073-70 KV	Keyed Different*
C4073-70 KA	Keyed Alike—PL927, \$PL926

Ⓢ-Discontinued. Call for closeout prices.

*KV indicates the majority of the quantity of locks will be keyed different. A lesser quantity will potentially be keyed alike to one or more key numbers. We can not guarantee that we can ship keyed DIFFERENT locks.

SWITCH LOCKS

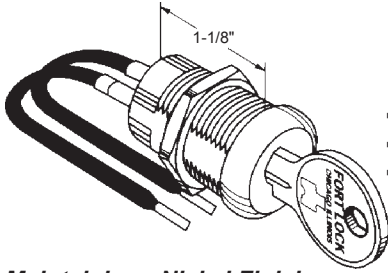

- 23000 Series Keyway
- Lead Length 10"
- 7 Amps - 110VAC (Resistive Load)

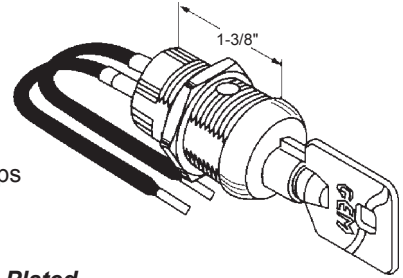

- GEM 7 pin Keyway
- Lead Length 10"
- 110-120VAC, 7 Amps (Resistive Load)

Maintaining - Nickel Finish

Stock No. Description
SW2-3118AD 2 key pulls at 12:00 & 3:00. Maintains contact at 3:00, open at 12:00.

Available KD or KA: **SPECIFY KEYING.**
Keyed Alike #: 217, 221, 224, 237, 238.

Momentary - Nickel Plated

Stock No. Description
SW20-1138MC Momentary contact, single pole, single throw. 90° CW turn contacts closed - spring back to 12:00, key removable.

Available KD or KA: **SPECIFY KEYING.**
Keyed Alike #: 27379, 27380, 27381, 27382, 27383

Momentary - Nickel Finish

Stock No. Description
SW20-3118MC 1 key pull at 12:00. Momentary contact at 3:00, springs back to 12:00.

Available KD or KA: **SPECIFY KEYING.**
Keyed Alike #: 217, 221, 224, 237, 238.

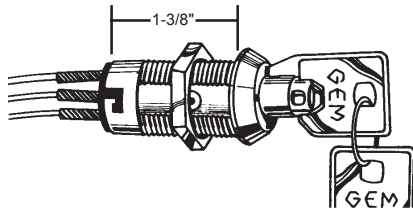

MFSW3-1138 KD or KA Multi-Function Switch Lock

Rekeyable switch lock - UL Rated. Maintaining & Momentary contact, single pole, double throw switch. 125/250VAC 7A (resistive Load) Lead length 10". Parts provided for 1)Maintained, 90° CW turn, key removable 12:00 & 3:00. 2)Momentary, 90° CW turn, Key removable 12:00, spring back.

Available KD or KA: **SPECIFY KEYING.**
Keyed Alike #: 27379, 27380, 27381, 27382, 27383

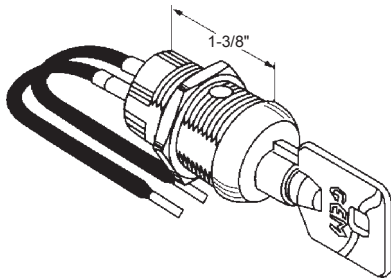

SW2-1138AD KD or KA Switch Lock - Maintaining

Maintains contact at 3:00. Single pole, single throw switch. 110-120VAC, 7 amps (resistive load). Key removable at 12:00 & 3:00. Lead length: 10".

Available KD or KA: **SPECIFY KEYING.**
Keyed Alike #: 27379, 27380, 27381, 27382, 27383

One phone call does it all — 1-800-848-1577

CIRCUIT/VENDING LOCKS



DISC TUMBLER CIRCUIT BREAKER CABINET LOCK



NL-C8070-2C

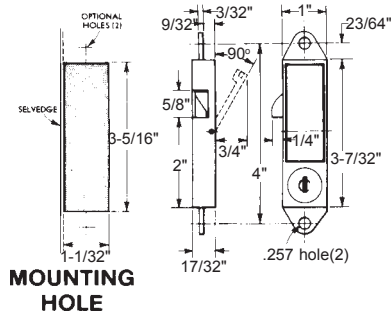

APPLICATION—For right handed metal doors of electrical circuit breaker cabinets.

OPERATION—Key removable in both locked and unlocked positions. Push plate operates spring bolt. Unlocked, push plate acts as spring latch.

KEYING—Supplied keyed alike only to B135A.

PACKAGING—Supplied with two keys, no mounting hardware.

FINISH—2C-Aluminum Enamel Finish

Stock #
NL-C8070-2C

Type of Mounting
R.H. Doors

Bolt Type
Spring Pivot

Bolt Travel
7/32"

Key Blank
D8786

HIGH SECURITY TUBULAR KEY LOCKS GEM 1000 SERIES LOCKS 7 PIN TUMBLER

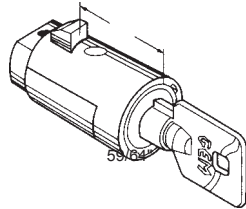

Inner Cylinder - Nickel Finish

Stock No. YPT-1010 **Description** Inner cylinder for POP-OUT T handles. Meets NAMA Standards

Available KD or KA: **SPECIFY KEYING.**

Keyed Alike #: 27381, 27382, 27383, 27384, 27385.

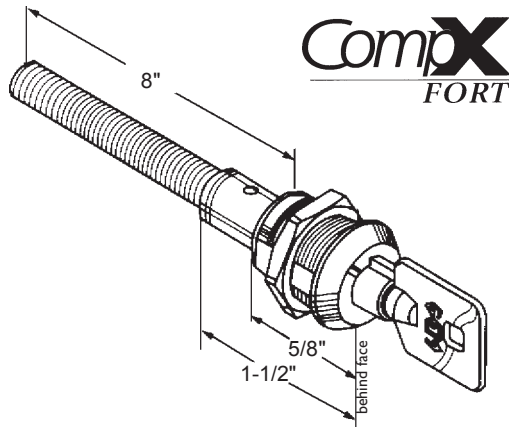

Stock No.	Keying	Key Pulls
TS-1058BD KD	Keyed Different	12 & 6
TS-1058BD KA	Keyed Alike*	12 & 6
TS-1058U KD	Keyed Different	12, 3, 6, & 9
TS-1058U KA	Keyed Alike*	12, 3, 6, & 9

*Specify Keyed Alike#: 27379, 27380, 27381.

18 Threads per inch.